



VOL. XXVII, NO. 4907.

HONOLULU, HAWAIIAN ISLANDS, SATURDAY, APRIL 30, 1898.

PRICE FIVE CENTS.

**J. Q. WOOD,**  
ATTORNEY AT LAW.  
—AND—  
NOTARY PUBLIC.  
OFFICE: Corner King and Bethel Streets.

**DR. C. B. HIGH,**  
Dentist.  
Philadelphia Dental College 1892.  
Masonic Temple. Telephone 318.

**A. C. WALL, D. D. S.**  
Dentist.  
LOVE BUILDING, : FORT STREET.

**M. E. GROSSMAN, D.D.S.**  
Dentist.  
98 HOTEL STREET, HONOLULU.  
Office Hours: 9 a. m. to 4 p. m.

**DR. A. J. DERBY,**  
Dentist.  
CORNER FORT AND HOTEL STS.  
MOTT-SMITH BLOCK.  
Telephones: Office, 615; Residence, 789.  
HOURS: 9 to 4.

**GEO. H. HUDDY, D.D.S.**  
Dentist.  
FORT STREET, OPPOSITE CATHOLIC MISSION.  
Hours: From 9 a. m. to 4 p. m.

**DR. M. WACHS.**  
Dentist.  
University of California.  
Beretania near Fort street.  
Office hours: 9 to 12 a. m. and 1 to 4 p. m.

**C. L. GARVIN, M.D.**  
Office—No. 537 King street, near Punchbowl.  
Hours—8:30 to 11 a. m.; 3 to 5 p. m.; 7 to 8 p. m.  
Telephone No. 448.

**MRS. F. S. SAVANT-JEROME, M. D.**  
HOMEOPATH.  
Has opened office No. 223 Hotel street.  
Woman's and Children's Diseases.  
Special studies of dietetics and physiatrics made.

**THE HONOLULU SANITARIUM.**  
1082 KING ST.  
A quiet home-like place, where trained nurses, massage, "Swedish movements," baths, electricity and physical training may be obtained.  
P. S. KELLOGG, M.D., Supt.  
Telephone 639.

**CHAS. F. PETERSON,**  
ATTORNEY AT LAW.  
—AND—  
NOTARY PUBLIC.  
15 Kaahumanu St.

**LYLE A. DICKEY,**  
ATTORNEY AT LAW.  
14 KAAHUMANU STREET.  
Telephone, 682.

**WILLIAM C. PARKE,**  
ATTORNEY AT LAW.  
—AND—  
AGENT TO TAKE ACKNOWLEDGMENTS.  
Office: Kaahumanu St., Honolulu.

**O. G. TRAPHAGEN,**  
ARCHITECT.  
223 Merchant Street between Fort and Alakea.  
Telephone 734. Honolulu, H. I.

**Consolidated Soda Water Works Co.,**  
—LIMITED—  
Esplanade, Cor. Allen and Fort Sts.  
ROLLISTER & CO., - - AGENTS.

**P. O. Box 480 IXL Telephone 478**  
New and First-Class  
**SECOND-HAND FURNITURE**  
—OF ALL KINDS—  
SOLD CHEAP FOR CASH.  
Highest Cash Price paid for Second-Hand Furniture at IXL Corner King and Nuuanu Streets.  
**S. W. LEDERER.**

## A FEW SHARES

of the following Stocks have been placed in our hands for sale at prices that should be of interest to intending investors:

Ewa Plantation Co.  
Paia Plantation Co.  
Kahuku Plantation Co.  
Hawaiian Electric Co.  
Inter-Island S. N. Co.  
Wilder S. S. Co.

**Hawaiian Safe Deposit and Investment Company.**  
GEORGE R. CARTER, Mgr.  
Office in rear of Bank of Hawaii, Ltd.

## SPECIAL BUSINESS ITEMS.

**IF YOU BUY A SINGER,**  
You will receive careful instruction from a competent teacher at your home.  
You can obtain necessary accessories direct from the company's offices.  
You will get prompt attention in any part of the world, as our offices are everywhere and we give careful attention to all customers, no matter where the machine may have been purchased.  
You will be dealing with the leading company in the sewing machine business, having an unequalled experience and an unrivalled reputation—the strongest guarantee of excellence.  
Sold on easy payments. Repairing done.  
B. BERGERSEN, Agent.  
16½ Bethel Street, Honolulu.

The City Carriage Company possess only first-class hacks and employ only careful, steady drivers.  
Carriages at all hours.  
Telephone 113.

**JOHN S. ANDRADE.**  
**TOURISTS' GUIDE**  
THROUGH HAWAII.  
PRICE, 60C.  
BEAUTIFULLY ILLUSTRATED.  
FOR SALE BY ALL NEWSDEALERS

**WOMAN'S EXCHANGE.**  
215 Merchant St.  
HAWAIIAN CURIOS—Leis, Kapa, Nihau Mats, Calabashes, Idols, Fans, Shells, Seeds, etc., etc.  
SAMOAN TAPAS, Carved Emu Eggs, Hula Drums, Gourds, etc., etc.  
Point Lace Handkerchiefs, Doilies, Fayal work and Hawaiian Dolls.  
Telephone 659.

**DR. GEO. J. AUGUR.**  
HOMEOPATHIC PRACTITIONER AND SURGEON.  
Special attention Given to Chronic Diseases.  
Richards street, near Hawaiian hotel.  
Office and Residence the same.  
Office hours: 10 to 12 a. m.; 3 to 4 p. m.; 7 to 8 p. m. Sundays 9:30 to 10:30 a. m. Telephone 733.

**MISS TOWNE.**  
TEACHER OF CHINA PAINTING  
Studio, Second Floor Pacific Hardware Company.  
Class Days—Mondays and Tuesdays, afternoon; Wednesdays and Fridays, morning.

**CHARLES CLARK.**  
ATTORNEY AT LAW.  
121 MERCHANT STREET.  
Honolulu Hale. Tel. 345.  
Up Stairs.

**The Name Plate That Marks the High Grade Wheel.**



**H. E. WALKER, Agt.**

## VOLUNTEER NO. 1

An American Lady Leaves Today for the War.

## WELL FITTED FOR HER MISSION

Proposes to Enter the Hospital Service for Old Glory Soldiers.

To Mrs. J. Hyde Thomas of this city will belong the honor of being the first civilian to leave the Hawaiian Islands for the purpose of following the fortunes of war with Old Glory. Mrs. Thomas, who is a trained nurse, goes by the S. S. City of Peking today. She will offer her services as field or hospital nurse for troops of the United States in the war with Spain.

Mrs. Thomas has had in thought this step ever since the receipt by the Alameda of the news that war seemed absolutely certain. To a representative of the Advertiser, Mrs. Thomas said last evening that she wished to avoid any advertisement or notoriety. She quietly remarks that she is simply following the dictates of her conscience and will be more than satisfied if she can be in any way of service to the country and flag of herself and ancestors.

Several evenings since Mrs. Thomas called upon Harold M. Sewall, the American Minister Resident and mentioned to that gentleman her plans. Mr. Sewall was at once touched with emotions of patriotism and enthusiasm and on the instant proffered every assistance in his power. Mrs. Sewall declared that she must cooperate with her husband and at once prepared letters to her sister, Miss Asche, of San Francisco, introducing and commending Mrs. Thomas. The Minister furnished letters that will immediately place Mrs. Thomas in communication with persons who can further her noble plans. Mrs. Thomas was delighted with the manner in which her mission was favored by the Minister Resident for the United States and praises him highly.

This lady who is showing the way to Americans in Hawaii has been in the Islands a number of years. Her home has been with Mrs. S. L. Dexter, on Richards street. Mrs. Thomas has followed her calling as professional nurse and has been with some of the some prominent families of the city. Mrs. Thomas is from a State that has been called cranky politically, but that has given to the country some of the foremost public men and that may be depended upon to do its share in meeting any enemy of the flag. Colorado was her home and in his lifetime her husband was well known there. Mrs. Thomas is an educated, refined woman of stout heart and has a store of health that she believes will resist the climates of Florida or Cuba. She hopes to be able to at once proceed to an assignment for active service. The lady has in Honolulu many friends who will miss her greatly, who will wish her well and who will not be much surprised at her course, knowing her to be a woman of determination and of intense love of her country.

**Trip to Laysan.**  
When the Inter-Island company's steamer Noeau leaves this port for a visit to Laysan Island she will be in the charter of the Pacific Guano & Fertilizer Co., H. Hackfeld & Co., Ltd., agents. It is said that the steamer will visit a number of islands or sandspits to the southward and will be a fortnight or more in making the trip. It takes about three days to steam down and four or five to run back. Supplies and men will be carried and men may be brought back.

**Railway Case.**  
Trial in the Government and Oahu railway case proceeded all of yesterday. After the attorneys had finished with Mr. Rowell, Superintendent of Public Works, there was called to the stand Minister Damon. The Minister of Finance was closely questioned for several hours by the attorney for the rail-

way. He was asked particularly as to Governmental plans on wharfage. To all questions Mr. Damon replied very carefully. Attorney Kinney read from papers and asked about discussions in Cabinet meetings.

**Mohican's Departure.**  
The U. S. S. Mohican, Book commander, started out for San Francisco at an early hour yesterday morning, according to orders received from the Navy Department on the Alameda. She arrived off Waialae, on the approach to Koko Head, when it was found that something was wrong with her rudder. She cast anchor close inshore at about 8 o'clock and proceeded at once to the work of repairing which was finished at about 3:30 o'clock in the afternoon, when the Mohican proceeded on her way.

**Off for Molokai.**  
There were about 40 passengers for the Molokai Settlement on the Inter-Island steamer Noeau last evening. The party included Legislative committees and members, all the members of the Board of Health who were able to leave the city, several invited guests—principally medical men—and representatives of the press. The Noeau will be at Kalaupapa this morning. The day will be spent in inspection of the settlement. There are quite a number of cases for the board to handle while on the Island.

**Will of Stephen Spencer.**  
Senator Cecil Brown, an attorney filed in Circuit Court yesterday the last will and testament of the late Stephen Spencer, whose name will be familiar to all kamaainas. Mr. Spencer died in England in December last at a ripe old age and after a useful and noble life. While in Hawaii he held many positions of honor and trust. For a number of years he was chief clerk in the Interior Department. Mr. Spencer after his career here regarded Hawaii as his home and so stated in his will. His beneficiaries are immediate relatives. There is disposed of property in London of the value of \$90,000 and in Hawaii of the value of \$66,000. The will is beautifully prepared and has the approval of the English High Court. J. M. Dowsett is made administrator of the estate in these Islands. In dictating the will Mr. Spencer spoke of Mr. Dowsett as "J. M. Dowsett, generally called 'Jack' Dowsett."

**A Big Bathing Party.**  
The young ladies of Kawaiahou Seminary, with chaperones, had possession of Sans Souci, Waikiki, for nearly all of yesterday afternoon. This was a special outing for the pupils of the boarding school. Arrangements had been made several days ago for the excursion and there were no mishaps. A delightful time was had. There were any number of swimming races and water games. There were 85 girls in the party.

**Made Baggage Vans.**  
This complaint is made by several ladies and gentlemen who are regular patrons of the tram company: That car No. 4, leaving the corner of Fort and King at 1:05 p. m., had yesterday three trunks of a Japanese on the rear platform. Passengers could only enter from the front of the car and inside found a number of ill-smelling bundles belonging to Japanese.

**Juniors to Wheel.**  
M. A. Cheek, assistant secretary of the Y. M. C. A., will take the junior members of the association on a wheel run this forenoon. The boys will meet at the association hall at 9 a. m. and will be away on the outing until 12 o'clock noon.

**For a Kauai Dance.**  
The Mikahala took to Kekaha yesterday afternoon a party of some 12 or more young people who go to attend the dance at the Glade home in Kekaha tomorrow night. Their names may be found in the passenger list in this issue.

**CRISP PARISIAN NOVELTY.**  
Gren a bandes, the latest Parisian craze in dress goods for summer, street and evening wear. Lightest and hand-somest goods ever placed on the market. Every conceivable color and combination of colors and figures. To be had only at L. B. Kerr's, Queen street.

## TWO WHARF PLANS

Presentation of a Pair of Widely Varying Schemes.

## COMPARISONS BY DILLINGHAM

One Long Dock and Slips—Contraction—Enlargement—Opinion of a California Engi

MR. EDITOR:—Representative Wilder has asked Acting Minister Cooper some interesting questions bearing upon the plan which the Government proposed last January to carry into effect, as soon as possible. It was claimed then, as it is now upon good authority, that the plan to construct a wharf across the northwest arm of the harbor of Honolulu, if not a crime would certainly be a very grave mistake, both from an economical and financial standpoint. There are at present a little over 4,000 lineal feet of wharf room available in the whole harbor. The question of expanding or contracting the very limited area of wharf room in our harbor, is of very grave importance to the entire commercial interests of the country, and especially to all property holders in and around the city of Honolulu, as well as to every taxpayer in the land. Without imputing any motives to the Government for their remarkable decision to construct a wharf from the Lime Kiln to "Summer's House," a distance of say 2,000 feet, practically cutting the harbor down to nearly one-half its size; a few figures to show a comparative and approximate cost of the two plans, may be found interesting.

The plan for enlarging the harbor, which has been called "the O. R. & L. Co.'s plan," as exhibited in the Advertiser, January 20, 1898; showed a wharf which was to be built say 50 feet wide from the makai side of the extension of Queen street, and 800 feet long. Directly makai of "Queen street wharf." Another wharf is shown on the same map—size 800x100. The last named wharf would be approached by a bridge connecting it with the north-west end of Queen street, where it turns up to unite with King street. These two wharves would supply 2,400 lineal feet of room for docking ships of all largest or smallest size. About six acres of the mud flat where it is proposed to erect the two wharves, was owned by Mrs. Youmans. That property should be taken over by the Government at a fair valuation, for the purpose named. Makai of the two wharves named, and as also shown on the map referred to, are wharves 50 feet wide, located within the boundaries of the fee simple property purchased in 1890, by the O. R. & L. Co. from the Bishop Estate and Mrs. Youmans. As the question of certain rights held by the O. R. & L. Co. under its franchise, and whether or not the said company shall be allowed, at its own cost, to erect wharves on its own land, for the uses and purposes of its own business, of its own creation; is now before the Courts and Legislature, we will leave that part of the natural basin for harbor enlargement, out of our present calculation, and only consider the two plans which relate to Government increase of wharf room, upon their respective financial merit.

As a basis for comparative statement of cost of wharf construction, we will make the estimate at \$1 per square foot.

## ESTIMATED COST AS PER PLAN OF O. R. & L. CO. FOR GOVERNMENT WHARVES.

1st. Queen Street Wharf, 800ft. x 50ft.—40,000ft. @ \$1—\$40,000.  
2d. Queen street Wharf "annex," 800ft. x 100ft.—80,000ft. @ \$1—\$80,000.  
3d. Bridge connecting wharf "annex" with N. W. end of Queen street, 150ft. x 50ft.—7,500ft. @ \$1—\$7,500.  
4th. Dredging two slips or docks, say 250ft. x 800ft. x 27ft.—200,000 cub. yds. @ 30 cts.—\$60,000. Total cost, \$187,500.  
This cost (\$187,500), is for 2,400 lineal feet of wharf room, say \$78.13 per lineal foot, conveniently located for the business of the town. The Government ought to realize by sale or otherwise at least \$30,000 for the material dredged to be used as "a fill."  
ESTIMATED COST to carry out the plan of the Government to construct a wharf commencing at the Lime Kiln and extending to "Summer's House," a distance of 2,000 feet, wharf to be 100 feet wide.

1st. Wharf 200ft. x 100ft.—200,000 sq. ft. @ \$1—\$200,000  
2d. Cost of dredging on harbor side of wharf, 75ft. x 2,000ft. x 27ft. deep. Present average depth to be dredged say 13ft. 6in.—75,000 cub. yds. at 30 cts.—22,500  
3d. Cost of rock retaining wall across front of mud basin say 700ft. by average width 15ft. by depth 27ft., allow settling in soft mud 13ft. Total area of rock embankment say 700ft. long 40ft. deep and an average of 15ft. wide, equal 15,555 cubic yards at \$1—15,555

Total cost ..... \$238,055  
This is for 2,000 lineal feet of wharf room, which is a total of \$50,555, more than the estimated amount required under the plan of the O. R. & L. Co. for 2,400 feet which was \$78.13 per lineal foot, while the Government plan would cost \$119.02 per lineal foot, a difference of \$40.89 per foot, over 50 per cent more.

The expense of keeping such a structure in repair, nearly a half mile in length running straight away from the business part of the town is suggestive, not only in consequence of the high cost of such a structure to be used for the combined purpose of wharf and road over which heavy teaming must be driven (every ton of freights loaded or discharged at the extreme makai end of this wharf must be hauled over all the rest of that structure) but also for the present an unnecessarily heavy expense for hauling such a long distance.

In an interview with one of the Cabinet Ministers which was published some time since, the Minister was reported to have said in effect, "this gor.hienec x—2x-1. Off. k-2el: plan (referring to the long wharf plan), will be a benefit to the O. R. & L. Co. and all concerned, and if later it is found necessary to extend wharves into the mud flat, it will be 'easy' to cut slips through the proposed long wharf."

It may be well before any more progress is made with the Government plan to consider this 'easy' plan of cutting docks through a wharf 100 feet wide, and what it will cost taxpayers to make such 'easy' changes to correct gross errors in so-called harbor improvements. Let us assume then for example that the Government have already constructed their long wharf or at least have extended it across from Lime Kiln to the O. R. & L. Co. present wharf, say 700 feet; two or three years have elapsed and the business of the O. R. & L. Co. alone requires more wharf room than all that has been supplied by the Government. Now the Government proposes to utilize the mud flat. To do this four slips are cut through the 700 feet wharf, one 150 feet wide, and three more each 125 feet wide, making in all 425 feet. This change will make it possible now to utilize the whole mud flat, which was so ruthlessly cut off. This "easy" undertaking will cost besides the loss of wharf cut away, (425ft. x 100ft.—42,500ft. @ \$1—\$42,500). Expense of drawing piles, removing super-structure of wharf cut-away ..... \$ 6,000  
First cost of retaining rock wall ..... 15,555  
Removing rock retaining wall Loss of wharf removed, \$42,500 Less material, some of which may be used again ..... 8,500

Total loss through change of plan ..... \$ 63,555  
The original cost of 2,000 feet wharfage was ..... \$238,055  
Add above expenditure for "easy cut" ..... 14,000

The wharfage now reduced to 1,575 feet will cost ..... \$252,055 or an average of \$158.76 per lineal foot, while the opposing plan costs \$78.13 per lineal foot, less than one-half.

(Continued on Second Page.)

Royal makes the food pure, wholesome and delicious.

**ROYAL BAKING POWDER**  
Absolutely Pure

ROYAL BAKING POWDER CO., NEW YORK.



## A Bit for Two Bits

And some for four and more. These are JENNINGS' BITS, of which we have a full assortment. Ship and house carpenters' Augers, German Bits, Gimlet Bits, Car Bits, Extension Bits, and all sorts of Bits.

Of other tools we will just mention the old, well-known Heller Brothers' Farriers' Tools, of which we carry a full line. Every farrier admits these to be the best made on earth.

We cannot give you a list of all the tools we carry in stock, but if wanting anything in this line you are about sure to find same at—

**E. O. HALL & SON, Ltd.**

## A LARGE INCREASE OF BUSINESS.

NEW YORK, April 5.—The sales of the Remington Standard Typewriter, the world over, for March this year, largely exceeded any previous month in its history. Typewriter sales are a good barometer of general industrial conditions.

**H. HACKFELD & CO., Ltd., Sole Agents.**

HAMAKUA PLANTATION,  
PAAULO, HAWAII, H. I.

MR. J. G. SPENCER,  
PACIFIC HARDWARE CO.,  
Honolulu.

DEAR SIR:—The Secretary Disc Plow I purchased from you is giving us satisfaction. We are using it to plow under a crop of lupins. They are three feet high and very thick. Your plow turns them completely under, at the same time plowing the land fourteen inches deep.

I feel satisfied that with this plow the draft for the same quantity and depth of work is as 6 to 8. That is, with the old plow, to do the same work, it takes 8 good mules; with your plow it takes only 6, and they are less tired at night.

Please send me another plow by first schooner leaving for this.

You are at liberty to use this in any way you may see fit.

Yours truly,  
**A. LIDGATE.**

## WATSON, LAIDLAW & CO.'S Water-Driven Centrifugal

Which does away with two-thirds of the floor space, three-fourths of the oil, and the whole of the belting required for drying sugar with the ordinary machine. May be seen in motion on application to

212 Queen St. **ROBERT CATTON.**

## CATTON, NEILL & CO. Founders and Machinists.

213 Queen St., bet. Alakea and Richards Sts., Honolulu.

Invite Enquiries for General Ironwork; Iron and Brass Castings. Ships' Blacksmiths. Cemetery Railings and Crestings Made to Order: Samples on Hand.

REPAIRS PROMPTLY ATTENDED TO.

TEL. 410.

**Read the Hawaiian Gazette**

## TWO WHARF PLANS

(Continued from First Page.)

The situation of the wharf as proposed by the Government is not at all suited to the requirements of the railway. It would stand nearly east and west when the wharves for railway use should stand nearly north and south, to be convenient for placing cars alongside ships. All additional expense incurred through such awkward unbusinesslike arrangement of bringing ship and car together, is loss—an unnecessary loss that must be borne by all the people having freight interests on that side of the harbor. Perhaps some one who "knows all about it" will be good enough to explain in what way the "people" are to be benefited by the consummation of the Government plan. No one yet has done so!

In closing, permit me to add: Mr. G. F. Allardt, a civil engineer of high standing upon whose survey and report the entrance to Honolulu harbor was deepened to 30 feet a few years since; has, unasked, submitted his views on the very subject herein discussed, in a letter addressed to the undersigned. As Mr. Allardt would be considered authority on harbor improvements anywhere in the world, it has been suggested by some prominent men who have read the letter that it ought to be printed for the benefit of the public, especially as the author, is wholly disinterested, and expresses his unbiased opinion in a friendly manner. Thanking you for this indulgence, I am very respectfully,

B. F. DILLINGHAM.  
Honolulu, April 25, 1898.

B. F. DILLINGHAM, Esq., General Manager Oahu Railway & Land Company, Honolulu, H. I.

Dear Sir:—I have read with much interest the correspondence relative to the enlargement of Honolulu harbor as published in the "Advertiser" of January 18, 19, 20 and 21, copies of which you mailed me.

The importance of the subject, not only to your company but to the public at large, demands the most serious consideration. Being somewhat familiar with the conditions of your harbor, I take the liberty of herewith submitting a few facts and figures which, I trust, may prove of some value in solving the problem. I shall not touch upon the legal rights of the contesting parties, as that matter has, very properly, been submitted to the courts, but shall confine my remarks solely to the engineering and commercial features of the case, regardless of the real ownership or corporate rights in the premises.

For a clearer understanding of the situation I submit two maps: Map No. 1, showing the proposed plans of improvement and the part of Honolulu harbor under discussion, and Map No. 2, showing the general plan of harbor improvements adopted in San Francisco. Both maps are drawn to the same scale, 300 feet to the inch.

As I understand it the problem is how best to increase the shipping facilities in the northern arm of Honolulu harbor. The Government plan is to construct a substantial wharf, 600 ft. long and 100 ft. wide, across the mouth of the Nuuanu inlet, and to fill in, or reclaim, the shallow, tide lands between the wharf and the shore. (See Map No. 1). It is apparent, at a glance, that this arrangement will add only 600 feet to the available wharf frontage of the harbor. On the other

hand, the plan proposed by your company, which I will call the "Railroad Plan," provides for a system of parallel wharves and slips running about at right angles to the proposed Government wharf. This plan will eventually create an additional wharf frontage of 5,200 feet, or more than eight times as much as the Government plan. The construction of the wharves and the dredging of the adjacent slips would, of course, be carried on gradually, one at a time, as the necessities of commerce may demand.

The Government officials admit, it is true, that greater wharf accommodations will be required in the near future, in which event they say that "slips can then be easily cut into the long wharf now being built." This means, in other words, that two-thirds of this 600 ft. wharf must be "rooted up" and destroyed, and that then, after all, the railroad plan of parallel wharves and slips will be practically adopted. It may well be asked, why not build the wharf upon the correct line in the first instance instead of wasting the public funds in building a costly structure in the wrong place and afterwards pulling it down.

The Government further argues that the railroad plan involves too much dredging, and that dredging is expensive. This may be true, but an inspection of the map will show that the construction of the Government wharf not only necessitates a large amount of dredging from the wharf out to the 26 ft. depth at low tide, but also involves the cost of filling to street-grade the entire area lying between the wharf and the shore-line of the inlet—nearly fifteen acres of tide lands, requiring, at a rough estimate, about one hundred and fifty thousand (150,000) cubic yards of material, a large portion of which must again be

dredged out whenever the Government decides to cut out those slips; another uncalculated and wasteful expenditure of the public funds.

Furthermore, the Government plan, instead of enlarging the harbor, will in reality contract it, as its wharf extends some fifty feet farther into the harbor than do the pier-heads of the wharves proposed in the railroad plan.

Finally, should the Government wharf be constructed, the material in front of the same will be dredged out to a depth of, say, 26 feet at low tide, and the very serious question may then arise whether it will not become necessary to construct a massive retaining wall, or sea-wall, some 600 feet in length, for the purpose of preventing the soft mud from sliding back into the harbor; and then, when said slip-cutting process is begun, two-thirds of this costly sea-wall will have to be torn-out and removed—another waste of the public funds.

The wharf and slip system proposed by your company is, in no sense, a new experiment. With some slight modifications it has been adopted by the maritime cities of the United States, notably New York, Boston and Portland. In San Francisco, notwithstanding its five or six miles of available harbor frontage, the same system has been approved and adopted. It was recommended after mature consideration by a commission appointed in 1877, composed of such distinguished experts as Admiral Rodgers, of the U. S. Navy, Colonel Mendell, of the U. S. Engineers, Professor Davidson, of the U. S. Coast Survey, and Mr. T. J. Arnold, the then chief engineer of the Harbor Board. The general design is shown on Map No. 2. The wharves or piers, as they are here called, run out 600 feet from the sea-wall, and the slips between them are 200 feet in width. This width of slips was considered essential to obviate the great inconvenience and expense of vessels lying at outer berths hauling out to allow entrance and exit for vessels lying at inner berths at the same slip. I notice, by the way, that your proposed slips are only 150 feet in width. This is a little scant, but considering that the breadth of beam of the largest ship seldom exceeds forty feet, this width will answer the purpose fairly well, as it gives a clear passage of seventy feet for exit and entrance between vessels docked on both sides of the slip.

A noteworthy feature of the San Francisco plan is the Belt Railroad, so called, which will eventually be extended around the entire waterfront. The use of its tracks is made free by law, to all railroad companies. The method of connecting the tracks with the piers is also shown on the map. The main object sought to be attained was "to bring ship and car together," one of the most essential requirements of modern commerce.

Returning to our Honolulu harbor, it seems to me there can be but one opinion as to the relative merits of the two plans proposed. To sum up—the Government plan will add only 600 feet to the available wharf frontage and will actually contract the harbor; while the railroad plan provides for a future extension of some 5,200 feet of the wharf frontage, besides materially augmenting deep water area of the harbor.

In case the controversy is carried to the Legislature, I would suggest that you have prepared a large wall map, to be hung up in the Legislature hall while the matter is under deliberation. The map should exhibit all lines and objects likely to be referred to in the discussion. Have the lines made heavy, and the figures and lettering large and bold, in order that they can be plainly distinguished by all the members. Plenty of coloring will add to the effectiveness of the map. Draw to a scale, of say, 20 feet per inch, which will make the size about 9 feet by 15 feet.

I would further suggest that Mr. Kluegel, your Chief Engineer, come well fortified with figures on the relative cost of the two plans, especially in the matter of dredging, not forgetting to emphasize the advantage of utilizing the dredged material in reclaiming low waste lands, thereby adding to the taxable property of the city.

In conclusion, I desire to say, with all due respect to the gentlemen composing the Hawaiian Cabinet, (several of whom I have the honor to know), that the carrying out of the Government plan would in my humble judgment be a very grave error, and would result in irreparable injury to Honolulu harbor. Indeed, it may be the first step to drive the Honolulu shipping to the deep and more commodious waters of Pearl harbor.

Respectfully submitted,  
G. F. ALLARDT,  
Chief Engineer, 420 California Street,  
San Francisco, Cal., February 17, 1898.

## REWARD OF MERIT.

At the CHICAGO CYCLE SHOW in 1897, each visitor on entering the Show was handed a coupon reading as below:

"After viewing the exhibits, kindly fill in the name of the Bicycle which pleases you best as regards beauty and mechanical merit, and deposit the coupon in ballot box near exits. Name of Bicycle,....."

The "Shirk" received 17,489 ballots against 12,377 the next highest. When it is known that all the leading makes of wheels in the United States were on exhibition at this Show, the above speaks for itself. The HONOLULU BICYCLE CO. have secured the Agency for this strictly high grade wheel.

IT WILL INTEREST YOU TO CALL AND SEE IT.

The SHIRK is the best thing that ever happened.

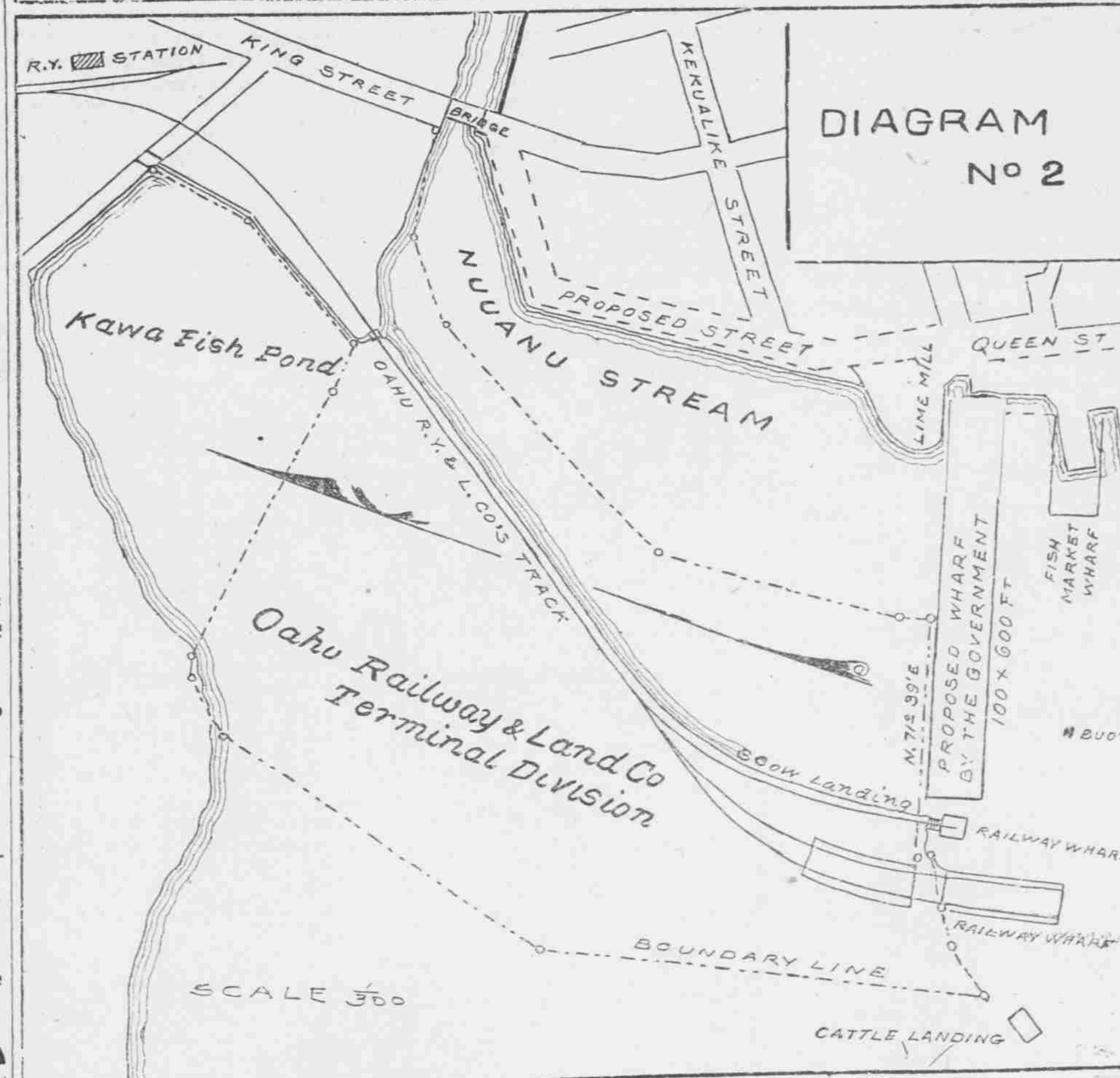
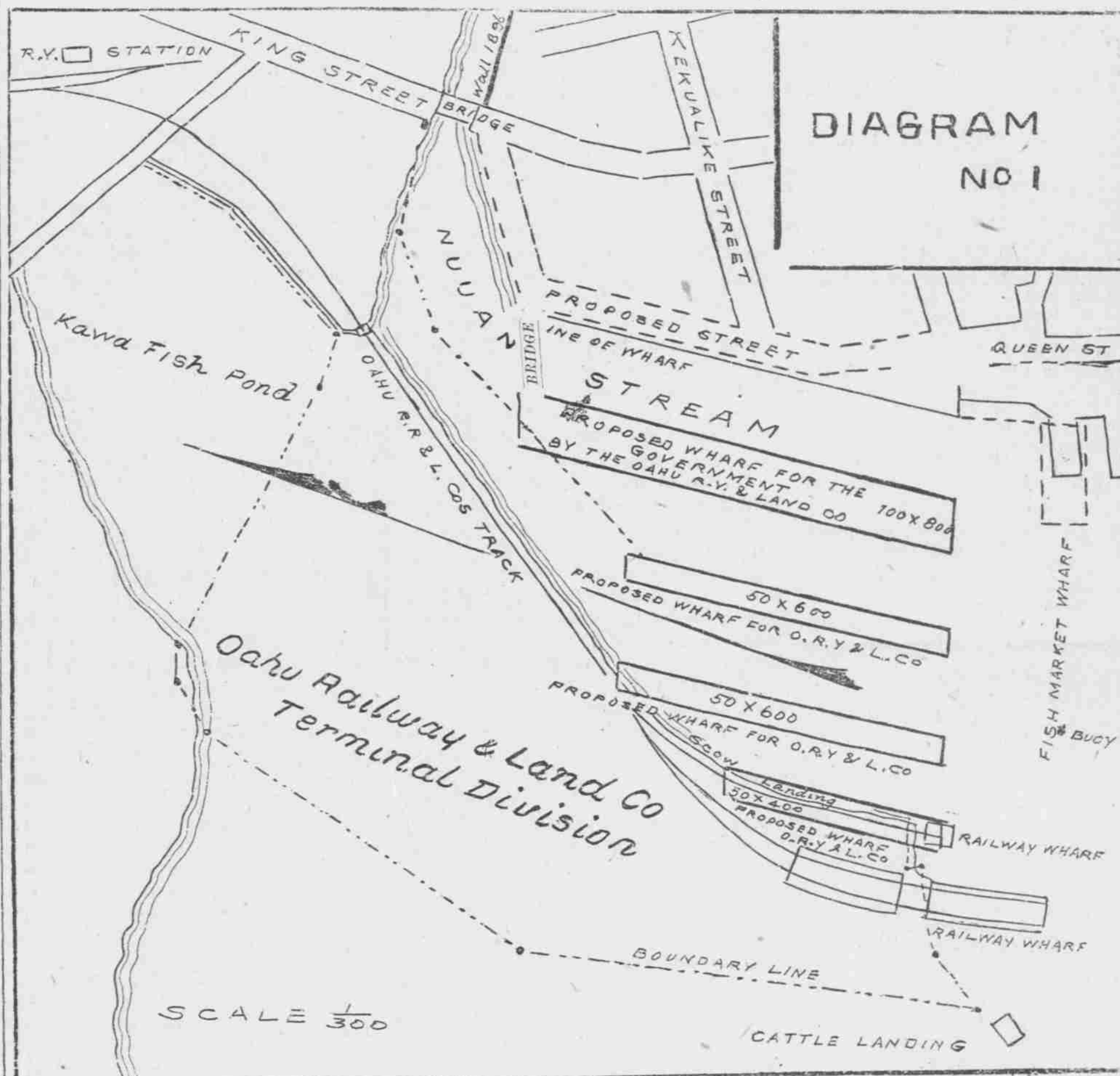



# Fashion's Mirror.

That is what this store is—and what it will always be—a mirror of fashions; wherein a lady may look and see reflected the newest style of the great centers of fashion. Ladies are always welcome to come and familiarize themselves with "the very latest," whether they wish to make purchases or not.

## The Dressmaking Department

Is in keeping with the Millinery Department. All that is the Latest in

## Dress Trimmings

**Miss M. E. KILLEAN.**

Arlington Block, Hotel St. Honolulu, H. I. Telephone 925.

## Don't Be Like the Man in Arkansaw!

Who could not repair his roof when it rained, and would not do so when it was not raining because it did not need it.

Get your Roof, Gutters and Plumbing in shape for the next heavy rains.

## Sanitary Plumbing a Specialty.

Farmers' Boilers and Extra Castings for all Stoves.

**JOHN NOTT.**

75-79 KING ST. TEL. NO. 31

## H. H. WILLIAMS. Undertaker and Embalmer.

LOVE BUILDING, 534-536 FORT ST. Telephone 816. Residence, King St. near Richards: Telephone 549.

## H. E. McINTYRE & BRO.

East Corner Fort and King Streets. IMPORTERS AND DEALERS IN

## Groceries, Provisions and Feed

General Agents for the Sanitarium Brand of Health Foods.

New and Fresh Goods Received by Every Packet from California, Eastern States and European Markets. Standard Grades of Canned Vegetables, Fruits and Fish. Goods Delivered to Any Part of the city. Satisfaction Guaranteed. Island Trade Solicited.

P. O. BOX 145. : : : : TELEPHONE 92.

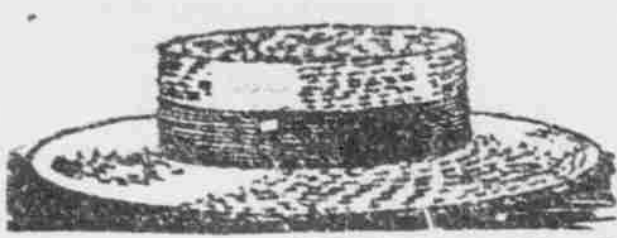

## K. Isoshima, HAT MANUFACTURER,

KING ST., Next to Castle & Cooke.

Every Style of Straw Hat Made to Order.

SILK GOODS, LACQUER WARE, CROCKERY WARE, HANDKERCHIEFS, TIES, ETC.

## J. M. MONSARRAT.

Attorney-at-Law, Real Estate and Financial Agent.

SEARCHER OF RECORDS AND NOTARY PUBLIC. COMMISSIONER OF DEEDS FOR THE STATES OF NEW YORK AND CALIFORNIA. LOANS PLACED AND NEGOTIATED.

Cartwright Block, Merchant Street. Telephone 68.

COFFEE LANDS for Sale or to Lease at Papa 2, Oloheoana 1, Kolo and Kaohae 4, in the celebrated Coffee District of Kona, Hawaii. These Lands will be sold or leased either large or small tracts to suit purchasers. Also:

FOR SALE.—Lands in Maui, Oahu and Molokai.

FOR LEASE.—A House and Lot at Waikiki. The house is partly furnished and contains seven rooms and a lanai, kitchen, pantry, two bath rooms, servant's room, Carriage House and Stables. Good sea bathing. These premises will be leased for a term of years at a reasonable rental. PASTURAGE at Kulikou, Oahu.

## TRAM IS REFUSED

Application for Wire Privileges Put Aside.

## TILT ON A LAND ACT

Discussion By Leobenstein, Robertson and Minister Cooper. Speaker Kaulukou Well.

The members of the House were most glad to see Speaker Kaulukou back in the chair again.

Rep. Robertson introduced a resolution to the effect that \$6,000 be appropriated to widen Union street in this city. Referred to the Public Lands Committee.

House bill 31, extension of franchise to the Hawaiian Tramways Co. for the purpose of building an electric railway, brought up in second reading. The majority report, recommending that the bill be tabled was adopted by a close vote.

Senate bill 27, relating to First Circuit Court, passed first and second readings and was referred to the Judiciary Committee.

House bill 74, increase of assessments, passed third reading.

House bill 52, amending Land Act of 1895. Rep. Robertson moved the bill be laid upon the table. Rep. Leobenstein, the introducer, was very much against this. Way should Mr. Robertson make the motion when the object of the bill was to bring white men into the country.

Under suspension of rules, Minister Cooper said the bill had received the most careful attention of the Government. It was certainly a good bill and in the line of a direct benefit to the people. The Government had received intimations from holders of large lands such as Pihouua announcing their willingness to surrender the leases on these in consideration of some proposed by the act. This could be easily done and would bring a large amount of land for small settlers.

Under the same suspension of rules, Rep. Robertson explained his reason for making the motion to lay on the table. The provision of the bill undoubtedly put the Executive at the mercy of the Land Commissioner whose consent would have to be obtained before the surrender of any lease could be accepted.

Rep. Robertson's motion to lay on the table was lost. Further consideration was postponed until Wednesday of next week.

Second reading and passage of House bill 57, dealing with foreign corporations.

House bill 82, relating to forced alienation of property, read second time by title and referred to the Judiciary Committee.

Senate amendments to House bill 59 were concurred in.

At 11 a. m. House adjourned to Monday.

## To Open Up Big.

Willson's circus opens near the fish market this evening in the largest tent Honolulu has ever seen. This is the return engagement after a successful tour of the Islands. About all of the old attractions have been retained, but besides the original company there is quite a troupe of local talent. The whole is in one show, for one price. Special features of the extra show will be riding and racing. Elsie St. Leon has improved very much in her riding during the past couple of months. "Funny Peanuts" is funnier than ever. The contortionists will perform some new feats. Alf St. Leon has taught his ponies some new tricks and some fancy marches. The dogs have been given a lot of special training. During this engagement Mr. Willson will give away a horse.

## The Late Mrs. Crabbe.

Mrs. Rebecca Auld Crabbe whose death in St. Louis at the age of 93 years was announced yesterday, was born in Baltimore, Md. Her husband Captain Crabbe arrived at this port in 1847 and until 1850 was the U. S. naval store keeper. After that time he became a ship chandler, and died in 1857. Mrs. Crabbe joined her husband here in 1852. Their daughter Mary Ellis, married Mr. Martin Collins of St. Louis in 1852, while he was on a visit to these Islands. He became and is now one of the most successful business men of that place.

## A Luncheon Party.

Mrs. J. G. Spencer gave a delightful luncheon to a number of ladies at her home in Nuuanu yesterday. The table was decorated with corymbis blossoms and daisies, the yellow and white making a very pretty effect. Those present were the following: Mrs. H. Vos, Mrs. H. H. Renjes, Mrs. B. Cartwright, Mrs. R. Walbridge, Mrs. G. P. Wilder, Mrs. F. A. Schaefer, Mrs. A. Fuller, Mrs. G. Carter, Mrs. H. Focke, Mrs. J. S. Walker and Mrs. Wood.

Mr. and Mrs. Francis Gay and family came up from Kauai on the Kauai yesterday. Mrs. Gay will remain in the city for several weeks.

## Called Crazy.

Tarawa, the Gilbert Islander who threatened people in the neighborhood of Kapukolo with a knife a few days ago, was examined by Dr. Emerson yesterday and is now at the Insane Asylum. Dr. Emerson found the man a victim of hallucinations. Tarawa says that a spirit comes down from Heaven at night and holds converse with him; also that there is a deep laid conspiracy against him. Tarawa has been here about 14 years.

## Your Money

saved if you like *Schilling's* Best baking powder—it does the most work to the cent.

Your money back if you don't like it.

## Annual Clearance Sale!

—AT—  
**JORDAN'S.**

... IN ...  
Real Ostrich Feathers and Tips.

IN WHITE, CREAM, BLACK AND COLORS

Reduced from \$15.00 to \$5.00 and others in proportion much below their first cost.

**For ONE Week!**

—ALSO—  
**CORSETS**

P. D., C. P., FRENCH WOVE AND PRIMA DONNA, at prices ranging from 25c. up.

Prices Are Lower Than Ever!

Come early and get first choice.

**E. W. JORDAN**  
No. 10 FORT STREET

## THE Customer's Approval

IS WORTH HAVING. It makes the very best sort of advertising. The saving of even the smallest fraction in buying is often worth, in the aggregate, your year's rent.

## STRONG POINTS.

The strong points on which we make our sales and keep our customers lies in the fact that we never attempt coercion. We don't approve of it under any circumstances. Many times we are asked relative to the different goods, and we gladly give it even if we have to sacrifice a penny by doing so. In the long run we lose nothing.

## STAPLE GOODS.

Last week we spoke of our canned goods, this week we will talk fruits in glass jars. The name of J. T. Morton, Heintz, Cross & Blackwell, Curtis, Durets & Co. and White are synonymous with privity in the following goods:

GREEN GAGES, DAMSONS, CHERRIES, RASPBERRY VINEGAR, DELHI SWEET CHUTNEY, RIPE OLIVES, BOILED APPLE CIDER FOR MINCE PIES, WHITE ONIONS, SWEET PICKLES, CHOW CHOW, GHERKINS, LIQUID RENNET FOR DESERTS, WATER WHITE VINEGAR, SUBLIME LUCCA OIL for SALADS & CANDIES.

Aside from these we have a varied assortment of Preserves, Jellies, Marmalades and Jams. All these goods are freshly packed in air tight glass containers and preserve their original flavors, and are simply what we claim for them, the best and cleanest of their kind.

**J. T. WATERHOUSE.**

H. HACKFELD & CO., Ltd.

General Commission Agents,

Cor. Fort and Queen Sts., Honolulu.

## Just Issued.

A valuable book, by  
PROF. WALTER MAXWELL, entitled,

## LAVAS AND SOILS

...OF THE...

## Hawaiian Islands.

PRICE, \$1.25.

For sale by the

**Hawaiian News Co., Ltd.**

Sole Agents.

## Bicycle Races !!! Bicycle Races

THIRD SEASON

—AT—  
**CYCLOMERE PARK,**  
COMMENCES

Saturday Evening, April 30.

**Fast Races!**  
**Close Competition!**

The Event of the Evening:

**KING - DAMON - GILES**

Three-Cornered Match Race, Tandem-Paced.

Seats on sale at Wall, Nichols Co. Doors open at 7 p. m. Races commence at 8 p. m.

## Art Pictures,

FRAMED OR UNFRAMED,

**King Bros' Art Store.**

110 HOTEL ST.

Be Sure and See the Plans of the

**PROVIDENT SAVINGS**

Life Assurance Society of New York,

Before Taking Out a Policy.

**E. R. ADAMS,**  
No. 407 Fort Street. General Agent.

## Horses!

A large shipment arrived by the Bkine. W. H. Diamond. Family carriage and driving horses, single or double teams. They are in good condition and will be sold on favorable terms. Apply at

**CLUB STABLES.**  
FORT STREET, HONOLULU.

## To the Public

**PABST BREWING CO.'s**

**FAMOUS MILWAUKEE**

## BEER

IS NOT offered to the public in competition with cheap brands.

**It Is Absolutely the Best!**

And for purity, it stands unchallenged, and is sold at fair market rates

—BY—

**W. C. PEACOCK & CO.,**  
Limited,

Sole Agents.



When other hoofs and other shoes Have not been faring well, And by the language that you use It's plain there's been a sell.

In such a scene, we Ask you not to worry, But remember the KING STREET SHOENING SHOP OF T. B. MURRAY

Every mule or horse shoe we put on is in itself a perfect gem. To get the like, ring up or send your critter to the shop of T. B. M.

We employ first class mechanics only.

"Prices to suit the times." Telephone 592.

**HUSTACE & CO.,**

—DEALERS IN—

**Wood and Coal**

—ALSO—

White and Black Sand

Which we will sell at the very lowest market rates. Telephone No. 414.

Robert Lewers, F. J. Lowrey, C. M. Cooke

**LEWERS & COOKE.**

Importers and Dealers in Lumber and Building Materials. Office, 414 Fort St.

**LEWIS & CO.,**

**Wholesale and Retail Grocers**

111 FORT STREET.

Telephone, 240. : : P. O. Box, 28

## TANSAN

Is the Drink If You Want a Good

**MINERAL WATER**

**E. R. ADAMS,**

Agent Hawaiian Islands.

**HONOLULU IRON WORKS CO.**

Steam Engines,

BOILERS, SUGAR MILLS, COOLERS, DRASS AND LEAD CASTINGS, And machinery of every description made to order. Particular attention paid to ship's blacksmithing. Job work executed on the shortest notice.

**WING WO TAI & CO.**

214 NUUANU STREET.

Ivory, Lacquer, Silver and Crockery Wares, Screens, Vases, Rattan Chairs, Crepes, Silks, Cigars, Etc., Etc.

**American Livery and Boarding Stables**

Cor. Merchant and Richards Sts.

**LIVERY AND BOARDING STABLES.**

Carriages, Surreys and Hacks at all hours.

TELEPHONE 400.

**Fresh Whole Wheat,**

In 10 and 50 lb. Sacks.

**Graham Flour,**

In 10 lb. Sacks.

**FEED OF ALL KINDS.**

**WASHINGTON FEED CO.**

COR. FORT & QUEEN STS.

Telephone 422.



# THE PACIFIC Commercial Advertiser.

W. N. ARMSTRONG - EDITOR.

SATURDAY : : : : APRIL 30.

## MORE CURIOUS TAXATION.

In analyzing the returns made of taxes assessed and paid, we have no desire to create any prejudice against the corporations. They are the present basis of our prosperity, and are not only entitled to protection, but to generous moral support from the community. The facts which we have presented regarding our system of taxation are simply undisputed. Whether or not we draw the soundest inferences from them is another thing. If the system is unjust the sooner it is reconstructed by the Legislature, the better it will be. The dominant party can have its own way at present.

When the table of the taxes levied and paid during the year 1897, is further examined, it appears that the European and American corporations paid a real estate tax of \$79,169, while the natives and part natives paid a tax of \$59,714. That is to say, the natives paid 75 per cent. as much as the corporations did that represent \$36,000,000 of paid up assets. It might be said in reply to this statement that the corporations owned only small areas of, or values in, real estate, and their assets consisted mainly of personal property. If, however, we look at the returns on personal estate, we find that the corporations paid \$148,640 on personal estate. If this amount is one per cent. on valuations, then it represents a valuation of all the personal property of the corporations of \$14,864,000. But the total valuation of corporate assets is \$36,000,000.

If the real and personal tax of the corporations, which is altogether the sum of \$227,809 is a one per cent. rate, then it represents an assessment or valuation of only \$22,780,000 of corporate property, while the paid-up assets of the corporations reach \$36,000,000. These paid up assets may not have this value as commercial things, but a difference or discrepancy of \$13,900,000 is a most significant item. On the face of it, it seems as if this large amount or difference was not taxed.

On the figures presented, and on the actual sales of Hawaiian crops abroad last year reaching over \$15,000,000, some sensational conclusions might be offered. The only object in analyzing these returns is to suggest that the system of taxation is not equitable, and that it should be reconsidered, as much in the interests of our personal safety and comfort in the future, as in the interests of justice and fair play.

## AN ASIATIC VOTE.

By reason of our statement that the dominant party is under obligations to deal justly with the Asiatics, in the matter of taxation, we have received several inquiries asking if we advocate giving the franchise to the Asiatics. These inquiries are only a repetition of the old argument used against the abolitionists by the copper heads: "You wish to free the slave? Do you wish your sister to marry a nigger?"

Doing the Asiatics justice does not make it necessary to give them the franchise. That is, it ought not to be necessary to give it to them. But if our own sense of right and justice does not impel us to be just, it will be "necessary" for the Asiatic to see to it that justice is done to him, and in time he will get it in some way. We are educating the young Asiatics in our public schools up to the Anglo-Saxon trick of having something to say about things, and if we do not wish them to bother us, we had better stop this scheme of educating them.

So long as we are honestly attempting to enforce "American Christian civilization," here with justice and equity, the Asiatics may not be very eager to ask for the franchise. But if "Christian civilization" means unequal taxation, or the commission of wrong, or the omission to protect rights, we may expect that, in due time, they will look around for some way of securing justice. It is easy enough to jump on another, if you have tied him up hand and foot. But if the other gets the chance, and in time it comes, he will give a return blow that may hurt.

Without annexation, we are about to try a most risky and novel experiment in the art of Government. The closer we bring that art to the principles of justice, the better it will be. But this does not necessarily involve the granting of the franchise. The Northern States of America would not, if they could, repeat the error of 1865 and give the negro an unrestricted franchise.

The Mariposa brought from the Colonies distant some 4,000 miles, 305 packages of onions, 70 sacks of potatoes, 22 boxes of apples. As these are products which can be cheaply raised here, why are they imported from points distant 4,000 miles? If it does not pay to raise

them here, why should we invite settlers and tell them that it does pay? Perhaps we do not like to say to them that the freight on a small package of vegetables from Maui to Honolulu is more than the freight on the same package from Honolulu to San Francisco. We do not like to put it into our glittering hand-books that transportation from Island to Island, distant only a few miles from each other is about as expensive as it is from Honolulu to China.

If regret at the departure of Admiral Miller today, is any evidence of a breach of neutrality, by this community, in the "unpleasantness" between Spain and the United States, then we have indeed grossly violated international law, and may be duly consigned to Spanish dungeons.

In all probability fighting has begun between Spain and the United States. Spain backed down in suspending hostilities, in the hope of making some arrangement. But Congress has refused to give further time for negotiations, and the President has promptly acted on the joint resolution declaring Cuba to be free and independent, without recognizing any special government over the island. The military and naval forces are probably now executing their plans, which have been well matured.

Even the laymen can read between the lines to some extent. The movements of the fleets will be made with unusual rapidity, and may astonish fighting men. To the outsiders it would seem as if the first blow struck by the American navy would be at Porto Rico, which is said to be the basis of Spain's coal supply. Vastly more important than heavy guns, or rapid firing guns, or torpedoes, is the item of coal. Spain fights at a distance of 2,000 miles from her coast lines. She is about to illustrate to the people of the United States the value of a coaling station like Hawaii. If she can hold Porto Rico against the American fleet, it will demonstrate with great force the value of these Islands as a strategic point.

## In Circuit Court.

Ninito Sumner, by her attorney, asks that she be given a hearing in the John K. Sumner case on May 5.

In the appealed replevin case of W. W. Wright against the Marshal, the Supreme Court approves the finding of the Circuit Court, which was against the Marshal.

In Hawaiian Commercial Company vs. Walluku Sugar Company, the plaintiff's bill for an injunction is disallowed and an appeal from the Circuit Court is taken.

## Surf Riding.

CANOEES CAN BE OBTAINED AT Wright's Villa, Waikiki, at any time on thirty minutes' notice.

The canoes are fine specimens and are manned by experienced natives.

CHARGES REASONABLE.

IN THE CIRCUIT COURT OF THE First Circuit, Hawaiian Islands. In Probate. In the matter of the Estate of BEATRICE M. G. LUCE, Minor.

On reading and filing the petition of W. S. Luce, the Guardian of Beatrice M. G. Luce, a minor, praying for an order for license to mortgage certain real estate belonging to the said ward on Wyllie street, Honolulu, being an undivided half interest in the home-estate of Mary E. Luce, deceased, consisting of 1.88 acres, with the improvements thereon, being a portion of Apana 1 and 2 of R. P. 7564, and setting forth certain legal reasons why such real estate should be mortgaged.

It is hereby ordered, that the next of kin of the said ward and all persons interested in the said estate, appear before this Court on Tuesday, the 3rd day of May, A. D. 1898, at 10 o'clock a. m., at the Court Room of this Court, in Honolulu, Oahu, then and there to show cause why an order should not be granted for the mortgage of such estate.

Dated Honolulu, H. I., April 16, 1898.

By the Court:

GEORGE LUCAS, Clerk.

4896-13t

## BASEBALL TODAY.

### Regiments and Honolulu to Meet for First Time.

The two real baseball nines of the 1898 league will cross bats at the Makiki diamond this afternoon. A contest worth while is anticipated, as the teams have been playing and practicing for a couple of months and have besides about the best material in the Islands. Hart will appear in the box for the first time this year. His arm seems quite strong again. He will pitch for the Regiment nine and Lemon will do the twirling for the Honolulu. J. Hansmann, one of the best men the Regiment team had, is out of it for the season. He wrenched a knee in last Saturday's game, and while able to be about, can take no chances with the game leg. Allan Jones, having a Cyclomere first prize in sight for this evening will not play with the Regiment. He will be substituted by Scanlon. These are the teams for today:

Regiment—Wilder c, Hart p, Davis 1b, Moore 2b, Gorman 3b, Lishman ss, Kiley lf, Bowers cf, Scanlon rf.

Honolulu—Dayton c, Lemon p, Willis 1b, Koki 2b, Pryce 3b, Thompson ss, Holt lf, Kaanoi cf, Pahau rf.

Hennessey has been released by the Regiment management and may be seen on the field later in the uniform of another aggregation. Mahuku (Old Reliable) will join the Honolulu in a couple of weeks now and will be warmly welcomed back to the grounds by patrons of the game.

At two different places last evening members of the Honolulu and Regiment figures out to a nice victory for today.

## Cheap AND Powerful.

A walk through most any section of this city at night when all is still will cause anyone to wonder why more sickness does not exist. The obnoxious orders from defective sewerage and many other causes ought to be overcome and that at once.

## 5 CENTS A GALLON.

Look after your cess-pools, water closets and garbage barrels. They are fever producers. Keep them free from offensive odors. It saves doctor's bills.

## ODORLESS AND HARMLESS.

Much simpler and more convenient than Chloride of Lime, Carbolic Acid and many other disinfectants. Used in all the prominent Hospitals and Public Buildings throughout the United States.

## PURIFY THE STUFF.

Sold in any quantity from 25 cents upwards. Give it a trial.

## HOLLISTER DRUG CO.

Sole Agents.

## SCROFULA

It is Foul Blood's Advertise-ment

But It is Soon Cured by Hood's Sarsaparilla.

Yes, Scrofula, if anything, may be called the advertisement of foul blood. It is the scourge of the world—offensive, painful, debilitating, stubborn and well nigh unendurable.

Outward application do not cure, they only drive the difficulty to new quarters. Emollients may palliate, they cannot abolish the evil. There is but one sure way out, and that is to eliminate the taint from the blood.

There is one remedy that can effect this, and it is the only one that, so far as we know, has almost invariably succeeded—even where the system has been poisoned by long years of taint, and the ravages to be repaired are tremendous. That remedy is Hood's Sarsaparilla. Read this:

"My daughter was afflicted with impure blood. There were running sores all over her body and they caused her much suffering. We tried medicines that were recommended as blood purifiers, but could not see that they did any good. A friend told me about Hood's Sarsaparilla and I began giving the girl this medicine. The result was that she was perfectly cured after taking a few bottles. She has had no symptoms of scrofula sores since that time." MARIETTA M. SMITH, South Middleboro, Mass.

## Hood's Sarsaparilla

Is the best—in fact the One True Blood Purifier. Insist upon Hood's; take no substitute.

Hood's Pills act harmoniously with Hood's Sarsaparilla.

HOBSON DRUG COMPANY, Wholesale Agents.

## TIMELY TOPICS

April 30, 1898.

The Summer is fast approaching and shortly the usual dry weather will prevail, and stock will suffer. It is all right with the big plantations, which have large steam pumps and get an ample supply of water (at an enormous expense), but a stock ranch does not need such a quantity of water and could not afford the price. But with our different sized

## AERMOTORS

we supply any quantity up to

10,000 Gallons an Hour,

at a minimum of expense. It is unnecessary for us to enlarge on the good qualities of the AERMOTOR as they are known to all people who have ever gone outside the city, as you can hardly travel a mile in any direction without seeing one or more of them.

Thorough tests at various times and under all conditions have made the Aermotor the Standard.

## HOLLISTER DRUG CO.

Sole Agents.

## The Hawaiian Hardware Co.

Limited.

307 FORT ST.

## BRUCE WARING & Co.

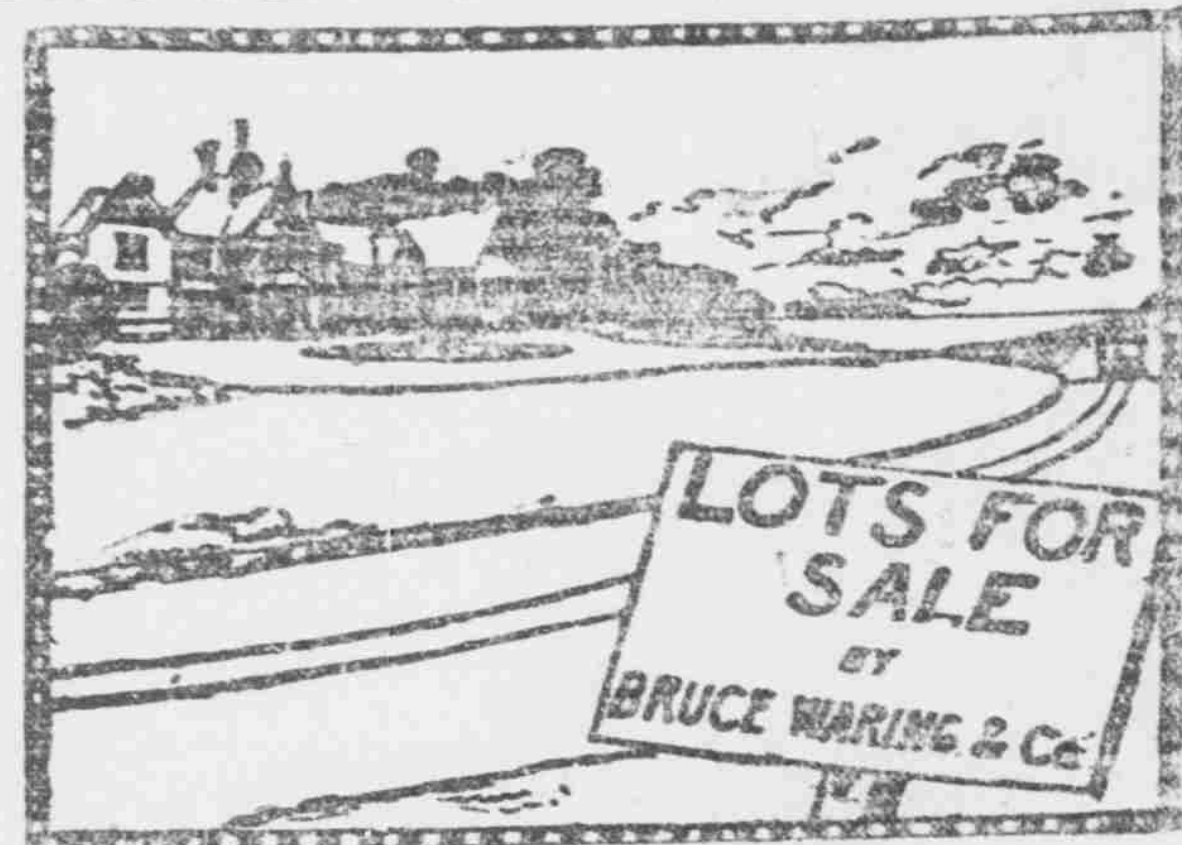

DEALERS IN

## Real Estate and Financial Agents.

Telephone 678....

314 FORT STREET, HONOLULU.

We are ready to purchase Large Estates near Honolulu and Hilo, and Coffee Lands on Hawaii.

Loans placed and negotiated; Estates taken charge of and managed. Choice Lots for sale at Kewalo, at Punahou and the growing City of Hilo on the installment plan. Houses built for investors. No trouble to show property to intending purchasers.

## Hollister & Co.

Import Cigars direct from Havana.

## Hollister & Co.

Import American Cigars direct from the Factories.

## Hollister & Co.

Import Manila Cigars direct from the Factories.

## Hollister & Co.

Import Smoking Tobaccos direct from the Factories.

## Hollister & Co.

Import Cheewing Tobaccos direct from the Factories.

## Hollister & Co.

Import Snuff direct from the Factories.

## Hollister & Co.

Import Three B Pipes direct from the Factory in London.

## Hollister & Co.

Have Havana and Manila Cigars in Bond.

## Hollister & Co.

Are TOBACCONISTS.

## Hollister & Co.

Are Located at—

Corner of Fort & Merchant Sts.



## Vapo-Cresolene

WHOOPIING COUGH, CROUP, ASTHMA, CATARRH, COLDS.

CRESOLENE being administered by inhalation, gives the safest and most effective means of treating the throat and bronchial tubes. Its efficiency in Whooping Cough and Croup is wonderful. Its antiseptic virtues render it invaluable in contagious diseases, as Diphtheria, Scarlet Fever, etc. Descriptive booklet with testimonials free. Sold by druggists.

HOLLISTER DRUG CO., Honolulu, H. I., Agents.



## For Sunburn, Rough Skin,

—USE—

## MAILE CREAM.

SOFT, WHITE SKIN is within the reach of every woman. All that is needed to make the complexion faultless is MAILE CREAM.

Removes every facial blemish, takes away redness and oiliness, preserves and beautifies the skin.

Prepared Only By

## BENSON, SMITH & Co.

—LIMITED—

## Further Reductions in Price! FOR ONE WEEK ONLY!

The balance of the goods saved from the big fire in London must be cleared this week, and in order to do this . . . . . we will offer them at the following prices . . . . .

New, Up-To-Date Shirt Waists, 35c; former price, 75c.

New, Up-To-Date Sailor Hats, \$1.00; former price, \$1.50.

French Organdies, New Patterns, 10c a yd; former price, 25c.

All Other Dress Goods in proportion.

An effort will be made to clear these goods by the end of the month. Now is the time to secure bargains.

L. B. KERR, Queen St.



## C. D. CHASE.

### Real Estate Agent

—AND—

### Notary Public.

407 Fort Street. Telephone 184.

### FOR RENT.

#### STORES.

A VERY DESIRABLE FURNISHED House. For terms apply.

**LARGE STORES** in the new Spreckels Block on Nuuanu street. For terms apply.

Nicey furnished Cottage, Nuuanu Valley, containing Parlor, Dining Room, 2 Bed Rooms, Bath, Servants' quarters. Will rent the above for 6 months to a desirable tenant.

HOUSE ON SCHOOL STREET, between Nuuanu and the bridge, makai side of street. Contains parlor, and back parlor, dining room, kitchen, pantry, bath and two large bed rooms. Rent, \$25.00 per month.

### FOR SALE.

MAGNIFICENT BUILDING LOT on Punchbowl slope, commanding an unobstructed view of the sea from Barber's Point to Diamond Head. Several large trees on the property and plenty of water. Lot has a frontage of 250 feet on Green street, 164 feet on Hackfeld street, and 205 feet on Spencer avenue. Three minutes' walk from tram car. Terms easy.

LOT ON LUNALILO STREET, having frontage of 150 feet. Two minutes' walk from car.

LOT ON LUNALILO STREET, having a frontage of 115 feet. Two minutes' walk from car.

### HOUSES FOR RENT.

### BUILDING LOTS FOR SALE.

## C. D. CHASE.

### Real Estate Agent and Notary Public.

407 Fort Street. Telephone 184.



### CHOICE EGGS FOR HATCHING.

From the following PURE-BRED Fowls of the choicest strains at my Punahou Poultry Yards, viz:—Buff Leghorns, Brown Leghorns, White Leghorns, Black Minorcas, Andalusians, Barred Plymouth Rocks, Wyandottes and English S. G. Dorkings, Perkin Ducks and Bronze Turkeys. Prices furnished upon application. Favors from the other islands will receive prompt and careful attention. A few choice Fowls for sale.

WALTER C. WEDDON,  
314 Fort St., Honolulu.

## Japanese : Novelties!

Ex Braemar and Rio de Janeiro.

BAMBOO BLINDS,  
MATTINGS (New Designs),  
PORCELAIN WARE,  
LACQUER WARE,  
HANDSOME KIMONOS,  
PAJAMAS, RUGS, ETC.  
ALL KINDS OF SHIRTS.  
SILKS! SILKS!

Don't buy until you have seen our stock. The Goods and Prices will Suit you.

## MURATA & CO.

HOTEL ST., COR. NUUANU.

ALL KINDS OF HATS.  
BRANCH HAT STORE, Nuuanu St.  
Telephone, 938. P. O. Box 206.

—EX "DORIC"—  
Grass : Cloth : Handkerchiefs!  
SILK HANDKERCHIEFS,

Silk Shawls,  
New Porcelain Cups and Saucers,  
Decorated Flower Pots,  
Rattan Chairs, Matting,  
Tea and Dinner Sets,  
Fire Crackers.

## WING WO CHAN & CO.

210-212 NUUANU ST.

## CHU YIP & Co.

(Formerly Wing Hing Loy.)

## Imported Dry Goods!

English, American and Chinese.

### DRESSMAKING

A Specialty. Low Prices to suit the times. Come and see our new stock and store.

NUUANU STREET, NEAR HOTEL (Opposite W. W. Ahana.)  
Telephone 157.

## COL. CORNWELL RESIGNS.

### Expresses Intent to Retire From Horse Racing Board.

Col. W. H. Cornwell has sent in his resignation as a member of the Executive Committee of the Hawaiian Jockey Club. There will be a meeting of the officers and committeemen of the club shortly to consider the resignation. It is very probable that it will not be accepted for Colonel Cornwell's fitness for the position which he wishes to retire from, is recognized by the Honolulu sporting fraternity.

Colonel Cornwell is a strong advocate for the adoption of the two-in-three heats method for light harness racing. His suggestions for a change have met with general approval. One horse owner has objected however, and while doing so "registered a kick" against Colonel Cornwell serving on the Executive board for the reason that the Colonel is the owner of a big string of horses.

Colonel Cornwell had already notified his colleagues on the Executive Committee, that he would have absolutely nothing to do with mapping out the race program for the Kamehameha day meet for the reason that he was the owner of horses that would participate. Although this has not been the rule theretofore, Colonel Cornwell insisted that it be adopted.

A member of the Executive Committee said last evening that he believed Colonel Cornwell could be prevailed upon to remain on the committee.

### Andrew Welch Men.

Walters, the Andrew Welch sailor, who was up on the charge of assault and battery on officers Peahi and Moau and who gave the mate of the vessel already mentioned on the night before arrival in port, a beating, is now a free man but he will not be allowed again aboard the Andrew Welch. He has signed clear of that vessel and yesterday tried to get a job on the Bennington, but was refused. He has hopes of getting a position on the steamer Upolu, now here.

Walters was at one time on the old Likilike and was in the town of Hilo for quite a while. He thinks he will remain on the Islands.

Mike Drewey who was hauled out of the hold of the Andrew Welch on the day of Walters' arrest, has been released and is now hard at work again on his vessel.

### Dr. Sun Yet Sin.

Several letters were received here by the S. S. Gaelic from Dr. Sun Yet Sin, the young Chinese patriot born and educated in Hawaii. The man who proposes to continue effort till the present dynasty in China is overthrown is now in Formosa. It has been his desire to operate from Hongkong, but he has been threatened with loss of his head if he sets foot in that colony. In view of this fact, Honolulu friends of the leader have urgently invited him to come to this place and practice his profession till revolution opportunity is more favorable. Sun Yet Sin may do this.

### Police Court.

In the Police Court yesterday morning Wai Sing was fined \$5 and costs on the charge of gambling.

Ah On, charged with assault with a deadly weapon on Kong Yuen, was sentenced to three months' imprisonment at hard labor and to pay costs of Court. Kekeha was reprimanded on being found guilty of the charge of assault and battery on R. Freitas.

The case of Hoong Hing for unlawful possession of opium was nolle pross'd.

### Sugar Tariff.

One of the big local sugar men said yesterday in speaking of the dispatch relating to proposed war tariffs in the United States: "If there is passed by Congress a bill increasing the tariff on sugar it will touch the produce from this country unless the same is especially exempted. It has never been thoroughly understood here that when the schedule is changed there must be particular mention of any exemption."

### Gilbert Island.

There were some 15 present at the woman's meeting in Kawaiaha Church yesterday afternoon. Among the number were three Hawaiian missionaries who returned from Micronesia on the Morning Star, as well as one Gilbert Islander. The latter gave a most interesting talk on the spread of Christianity in her home. Her remarks were translated into Hawaiian by one of the returned missionaries.

### Seriously Ill.

Mr. Moell, proprietor of the German bakery, has had a serious time with a carbuncle since last Friday. Little or no attention was paid to it at first, but Mr. Moell was finally forced to give up all routine work. Last evening an operation was performed which left him decidedly weak. It is the intention to again operate this evening if conditions will allow.

### Harbor Inspection.

Ministers Cooper and King had at the water front for an hour yesterday afternoon about a dozen of the Legislators who are handling in committee bills relating to wharves and dredging. There was explained by the Ministers and Harbormaster Fuller all the details of the plans of the Government and of the improvements that have been made or are under way. Members of the Legislature were much interested in the showing and will speak more intelligently of the matters under discussion.

### BOCK BEER

Is a treat indeed. That's delicious beer for you. As delightful as any one will ask for. Brewed in the early fall, of carefully selected hops and malt. Of mature age and double strength. Have you tried it at the Criterion Saloon? It's just the right temperature.

## Let Me See Your Eyes.

Maybe that headache comes from your eyes. If there's any trouble with them, I'll correct it with perfect fitting glasses. If I find you do not need glasses, I'll say so.

### EXAMINATION FRÉE.

Sight restored to all by

**S. E. LUCAS,**  
PARISIAN OPTICIAN.  
OFFICE: Love Building, Fort Street.

## What Makes the Man or Woman?



Clothes, of course! You hadn't thought of that. Why not buy clothes that are made in the right way? We are in the business to make all persons equal as far as clothes are concerned. Why not buy the best? Why not buy tailor-made clothes at the price of ready-ones? We can place you in the position to do so.

**Medeiros & Decker,**  
THE HOTEL STREET TAILORS.  
Waverley Block.

The best at the lowest price at HOPP'S.

## Facts Command Attention.

Our advertisements are accepted literally because they are written literally. They're the photographer's sensitive plate, picturing what is before them as it is. With a stock of the best qualities we must say BEST. Compare our claims and our offering and you'll find that they tally exactly. What need have we for exaggeration?

Last week we advertised that we would sell dining room chairs at an inside figure, and the response to our offer was so generous that we are tempted to offer you something entirely new to this trade. This week

### JUST TEN OF YOU

can each get a FIBRE MAT at the price you would pay for an ordinary one. These mats are something strictly new—they are sample sent us on approval. You can have them at a price that will be sure to meet with YOUR APPROVAL.

We are quite sure that you can't duplicate these handsomely made mats in this market. At any rate you can't DUPLICATE THE PRICE!

We also have a line of

### CORNICE POLES

finished in white enamel, oak and light woods of various kinds. These also will go for an inside figure.

Come in and see, there'll be no obligation to buy.

If you have never tried us on repairing and upholstering you don't know what old furniture looks like after it has passed through our hands.

**J. HOPP & Co.**  
Leading Furniture Dealers.  
KING & BETHEL STS

## Too High, You Say.

How do you know its too high?? Oh! from the size of your purse—A most excellent way of judging of course! But then, don't you know that we have so many things, just suited to your purse, and articles wherein quality has not been sacrificed either. Take the several new productions in Silverware for instance. If they are not the cheapest, brightest, and most artistic productions for the price, then we know nothing about Silverware, or about any part of our business.

A Large Tea Spoon, of good weight, fine pattern, Sterling Silver throughout for \$10.00 per dozen, engraved with a handsome initial on each, we think is well worth considering. And the whole Fork and Spoon line ranges as low. We have four new patterns already this Spring, and the Spring is hardly here. Who says we are behind the times?

We are here to STAY: That means that our guarantee lasts.

## H. F. WICHMAN

## Morning Star Curios!

THE CURIOS brought by the Missionary Steamer Morning Star, consisting of Fans, Mats, Shells, Bracelets, Necklaces, Belts, Coral, Girdles, Spears, War Clubs, etc., will be on sale at the

**GOLDEN RULE BAZAAR**  
316 Fort Street,

MONDAY MORNING, and those interested in CURIOS will do well to call early, as the Morning Star has been forbidden to trade with the South Sea Islands and it will in all probability, be a long time before such an opportunity is again offered.

**South Sea Island Dress Suits,**  
50 CENTS.

## We Repair Broken

**Cameras** No matter whether the trouble's due to a "won't work" shutter or a broken lens—or, in fact, if there's anything wrong with it—we'll fix it up in a way to suit and at a price that'll satisfy you.

**BIART** 404 1/2 FORT ST.  
JEWELER.

## There Are Just Two Kinds of Photos

Good photos, and others. We make just one kind here—good ones. And our photos are good in every way. Come to us expecting better photos than you've ever had made before. We won't disappoint you.

**WILLIAMS' ART STUDIO.**  
Fort Street.

## RECENT : ARRIVALS!

### FROM JAPAN:

**Handsome Silk Goods**

**BLUE CHINA WARE**

At more than reasonable prices.

### FROM SAN FRANCISCO:

**Gents' : Furnishings!**

Everything for the most fastidious as well as for every day wear.

## S. OZAKI.

WAVERLEY BLOCK,  
HOTEL ST.

**ON HAND:**  
A SHIPLOAD OF  
**NITRATE OF SODA**

An Excellent Fertilizer for

**Rattoons and Early Cane,**

And in the Dry Season.

Advance orders filled as received from the wharf.

For further details address  
**Hawaiian Fertilizing Company**  
A. F. COOKE, Manager.  
P. O. Box 136. Honolulu.  
Correspondence solicited.

**Mantel Clocks,**  
**Alarm Clocks,**  
**Hanging Clocks.**

**Gold and Silver Watches,**  
**Gold and Silver Jewelry,**  
**SILVERWARE,**  
**SPECTACLES.**

**Prices Are Right**

Manufacturing and repairing promptly done. Repairing fine and complicated Watches a specialty.

**M. R. COUNTER.**

507 Fort St.

ESTABLISHED IN 1858.

## BISHOP & CO.

### —Bankers—

TRANSACT A GENERAL BANKING AND EXCHANGE BUSINESS

Commercial and Travelers' Letters of Credit issued, available in all the principal cities of the world.

## Regrigerated Poultry

—AND—

**Fresh Salmon**

CONSTANTLY ON HAND.

**Metropolitan Meat Market,**  
Telephone 45.

### NEW STORE.

**Kwong Hing Chong.**  
315 Nuuanu St.  
**IMPORTED DRY GOODS.**  
English, American and Chinese.

### DRESSMAKING

A Specialty. Low Prices to suit the times. Come and see our new stock and store. Don't forget.  
315 NUUANU STREET.

**THE BEST THING IN TOWN.**

MY BICYCLE REPAIR SHOP.

**Keys Fitted, Locks Repaired,**  
Electroplating, and General Repairs at

**J. T. LUND'S,**

Opp. Club Stables. Fort Street.  
Telephone 398.

**J. R. Shaw, D.V.S.**

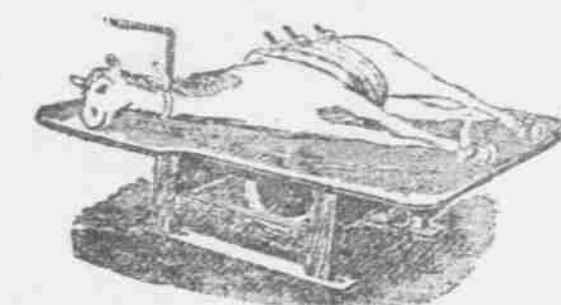

Office and Infirmary, - - 863 King St.  
TELEPHONE 796.  
Modern and Humane Treatment.

## WM. G. IRWIN & CO.

### —LIMITED—

### Offer for Sale:

**REFINED SUGARS**

Cube and Granulated.

**PARAFINE PAINT CO.'S**

Paints, Compounds and Building Papers.

**PAINT OILS,**

Lincol—Raw and Boiled.  
Linseed—Raw and Boiled.

**INDURINE,**

Water-proof cold-water paint. Inside and outside; in white and colors.

**FERTILIZERS,**

Alex. Cross & Sons' high-grade Scotch fertilizers, adapted for sugar cane and coffee.

N. Omlandt & Co.'s chemical fertilizers and finely ground Bone Meal.

**STEAM PIPE COVERING,**

Reed's patent elastic sectional pipe covering.

**FILTER PRESS CLOTHS,**

Linen and Jute.

**CEMENT, LIME & BRICKS.**

**AGENTS FOR**

**WESTERN SUGAR REFINING CO.,**  
San Francisco, Cal.

**BALDWIN LOCOMOTIVE WORKS,**  
Philadelphia, Penn., U. S. A.

**NEWELL UNIVERSAL MILL CO.**  
(Manf. "National Cane Shredder"),  
New York, U. S. A.

**N. OHLANDT & CO.,**  
San Francisco, Cal.

**RISDON IRON AND LOCOMOTIVE WORKS,**  
San Francisco, Cal.



A Model Plant is not complete without Electric Power, thus dispensing with small engines.

Why not generate your power from one CENTRAL Station? One generator can furnish power to your Pump, Centrifugals, Elevators, Pumps, Railways and Hoists; also, furnish light and power for a radius of from 15 to 30 miles.

Electric Power being used, saves the labor of hauling coal in your field, also water, and does away with high-priced engineers, and only have one engine to look after in your mill.

Where water power is available it costs nothing to generate Electric Power.

THE HAWAIIAN ELECTRIC COMPANY is now ready to furnish Electric Plants and Generators of all descriptions at short notice, and also has on hand a large stock of Wire, Chandeliers and Electrical Goods.

All orders will be given prompt attention, and estimates furnished for Lighting and Power Plants; also, attention is given to House and Marine Wiring.

THEO HOFFMAN, Manager.

## FOR SALE.

**California Horses.**

MATCHED TEAMS,  
FAMILY HACK AND  
SADDLE HORSES.  
Orders Taken for All Classes of Horses.

**STABLES, King St., Opp. Singer's Bakery**  
J. A. McDONALD.  
P. O. Box 422.



## CASTLE & COOKE IMPORTERS

### LIFE AND FIRE INSURANCE AGENTS

AGENTS FOR  
New England Mutual Life Insurance Co  
OF BOSTON.

Elm Fire Insurance Company  
OF HARTFORD.

C. BREWER & CO., L'D.  
Queen Street, : : Honolulu, H. I.

AGENTS FOR  
Hawaiian Agricultural Company, Ono-  
mea Sugar Company, Honouliuli Sugar  
Company, Wailuku Sugar Company,  
Waihee Sugar Company, Makee Sugar  
Company, Haleakala Ranch Com-  
pany, Kapapala Ranch.  
Planters' Line, San Francisco Packets,  
Charles Brewer & Co.'s Line of Bos-  
ton Packets.  
Agents Boston Board of Underwrit-  
ters.  
Agents for Philadelphia Board of Un-  
derwriters.

LIST OF OFFICERS:  
P. C. Jones, President; George H.  
Robertson, Manager; E. F. Bishop,  
Treasurer and Secretary; Col. W. F.  
Allen, Auditor; C. M. Cooke, H. Water-  
house, G. R. Carter, Directors.

WM. G. IRWIN & CO.,  
LIMITED.

Wm. G. Irwin, President and Manager  
Claus Spreckels, Vice-President  
W. M. Giffard, Secretary and Treasurer  
Theo. C. Porter, Auditor

SUGAR FACTORS  
—AND—  
COMMISSION AGENTS

AGENTS FOR THE  
Oceanic Steamship Company  
Of San Francisco, Cal.

The Yokohama Specie Bank  
LIMITED.

Subscribed Capital ..... Yen 12,000,000  
Paid Up Capital..... " 7,500,000  
Reserve Fund..... " 5,464,000

HEAD OFFICE: YOKOHAMA.

BRANCHES AND AGENCIES:  
Kobe, London, Lyons, New York,  
San Francisco, Shanghai,  
Bombay, Hong Kong.  
Transacts a General Banking and  
Exchange Business.  
Agency Yokohama Specie Bank:  
New Republic Bldg., : Honolulu, H. I.

CLAUS SPRECKELS. Wm. G. IRWIN  
CLAUS SPRECKELS & CO.,  
Bankers,

HONOLULU - - - H. I.  
SAN FRANCISCO AGENTS—The Nevada Bank  
of San Francisco.

—DRAW EXCHANGE ON—  
San Francisco—The Nevada Bank of San  
Francisco.  
London—The Union Bank of London (Ltd.).  
New York—American Exchange National  
Bank.  
Chicago—Merchants National Bank.  
Paris—Comptoir National d'Escompte de  
Paris.  
Berlin—Dresdner Bank.  
Hongkong and Yokohama—Hongkong and  
Shanghai Banking Corporation.  
New Zealand and Australia—Bank of  
New Zealand.  
Victoria and Vancouver—Bank of Brit-  
ish North America.

Transact a General Banking & Exchange Business  
Deposits Received. Loans made on Approved  
Security. Commercial and Travelers' Credits  
issued. Bills of Exchange Bought and Sold.  
Collections Promptly Accounted For

—THE—

Hawaiian Mercantile Agency

Will Collect your Accounts for  
you in a Prompt and Sat-  
isfactory Manner.

FOUR ACTIVE COLLECTORS are  
continually on the go, and others will  
be added with the increase of business.  
Returns made on all bills collected  
the day after collection.  
Special rates for special classes of  
bills.  
Ring up telephone No. 256, or call  
around at 210 King street, for further  
information.

REMOVAL NOTICE.

JOSE de ESPIRITO SANTOS  
Manufacturer of  
GUITARS, UKULELES, AND TARO-  
PATCH FIDDLES,  
Has removed to  
King St., near Punchbowl St.

## A BAIT.

A Window

Full of

Machine Oil

Of the best quality,  
at Five Cents a two  
ounce bottle.

One bottle to each  
customer.

This is not our  
only bait. Compare  
our prices with oth-  
ers for many articles.

W. W. DIMOND & CO.

THE  
PEOPLE'S  
STORE.

THE CLUB STABLES  
(Limited)

C. BELLINA, Manager.  
Fort St., near Hotel. Telephone 477.

Livery, Boarding and Sales Stables.  
PROMPT SERVICE, STYLISH TURN-  
OUTS, SAFE DRIVERS.

We are especially equipped to cater  
to your trade. Fair dealing and good  
service is what we depend on to get it.  
Dr. Rowat is always in attendance  
at the Stables.

Club Stables Hack Stand

Cor. Union & Hotel Sts.  
(Old Bell Tower.)

CAREFUL AND WELL INFORM-  
ED DRIVERS.  
FIRST CLASS CARRIAGES.  
HACKS AT ALL HOURS.  
Orders for Surreys, Wagonettes,  
Single or Double Teams at a moment's  
notice.  
Hacks Nos. 125, 183, 180, 70, 77, 81.

C. BELLINA, Mgr.  
Tel. 319. Stables Tel. 477.



More Beneficial Than All the Klondike Gold.

Warranted to Cure. For Sale Only by

PACHECO & FERNANDEZ.

Arlington Block, Hotel St.

CHONG FAT & CO.

Contractors : and : Builders,  
Carpenters and Cabinet Makers.

Furniture of all kinds constantly on  
hand and made to order.  
137 Nuuanu St., cor. Kukui Lane.

M. W. McCHESNEY & SONS.

Wholesale Grocers and Dealers in Leather and  
Shoe Findings.

Agents Honolulu Soap Works Company  
and Honolulu Tannery.

Read the Hawaiian Gazette  
(Semi-Weekly).

## WHEELS TO SPIN

Racing Will Begin Again  
at Cyclomere Tonight.

A Big Field of Riders in Fine Fettle.  
The Three Cornered Match.  
Pace—Music—Light.

This is the night of the grand re-  
vival of bicycle racing on the Honolulu  
scenic track. The program has been  
published already and all who delight  
to watch the wheel go around say that  
it is one of the very best ever offered.  
The big drawing event is the "three-  
cornered" match race between Damon,  
King and Giles, the leading amateurs.  
There has never yet been any betting  
to amount to anything on cycle races,  
but it may be said that the favorite in  
this event is King. It will be a paced  
race and the first man to get two heats  
takes the prize. It is confidently ex-  
pected that some very fast time will be  
shown. The three riders have some  
old scores to settle and the finishes will  
be of the whirlwind order.

In the professional event Allen Jones  
is slated as the winner. Whitman is  
not quite "on edge," but he has sur-  
prised all before this. John Manoa is  
in pretty good trim and Martin is rid-  
ing his trials in better time and form  
than he has shown at the game during  
his whole career.

The band will be on hand tonight. In  
the absence of Captain Berger, who has  
gone to Molokai on a professional trip,  
the Government musicians will be di-  
rected by Mr. Aylett. Some new and  
lively selections will be heard.

A thorough test of the light at Cyclo-  
mere was made last evening and was  
entirely satisfactory. The prices at  
this meet will be the same as usual.  
The track conduct is now an enterprise  
of a hui of town boys and if they are  
given encouragement they will keep  
the sport alive and on a good basis.

At the track last evening the man-  
agement announced the decision of  
changing slightly the program stipu-  
lation as to the professional events. By  
general request the first and second  
men in heats and the third in the fast-  
est heat will qualify for final. This  
will make a field of five in each profes-  
sional final.

C. L. Clement has turned over to C.  
F. Murray, the new manager of Cyclo-  
mere a letter from San Francisco intro-  
ducing Bert Crafts and J. E. Wing,  
noted professional and amateur res-  
pectively and both desirous of visiting  
Honolulu and racing. Cyclomere has  
been strongly recommended to Crafts  
by Ed Martin. Wing has lately smashed  
all two to ten miles amateur re-  
cords, but it is doubtful if the suggest-  
ed enterprise of bringing him here can  
be carried out. Crafts may come down.  
He would be sure to get on one match  
—perhaps two. Ed Martin, for his race  
with "Bob" Terrill, trained with Crafts  
and those who watched the pair work  
out were greatly surprised at the de-  
velopment of Crafts into speed.

The following challenge will add in-  
terest to the match race this evening:  
"Honolulu, April 29, 1898.

"Mr. Charles F. Murray, Manager Cy-  
clomere Park.

"Dear sir:—I take this means of is-  
suing a challenge to the winner of the  
three-cornered match between Damon,  
Giles and King which takes place at  
Cyclomere Saturday evening. The only  
conditions that I stipulate is that the  
race be best two in three, mile heats,  
tandem paced and that the said match  
take place at Cyclomere park during  
the present meet.

"H. LUDLOFF."

Rev. Dr. Berger Will Talk.

A fine treat will be the portion of  
those who attend the 4 o'clock meeting  
for men at the Y. M. C. A. tomorrow  
afternoon. Rev. M. L. Berger, D. D.,  
will be the speaker. His address will  
be a brief story of his recent visit to  
Egypt and the Holy Land, with espe-  
cial attention to a trip made up the  
river Nile. Rev. Dr. Berger is at all  
times a most attractive speaker. With  
such a topic as he has chosen he will  
prove doubly interesting and very in-  
structive. During his sojourn here  
Rev. Dr. Berger has lectured to the  
students at Punahou and was prevail-  
ed upon to make a few remarks at a  
recent meeting of the Social Science  
Society. There will be special music  
for the meeting tomorrow afternoon  
and the young man of Honolulu who  
fails to be present will be depriving  
himself of something of rare value.

PERSONAL MENTION.

G. B. Davis, a sightseer, recently a  
visitor to the islands, was heard to  
remark that in all his travels he had  
never been groomed in as satisfactory  
a manner as at the Criterion Barber  
Shop. Individual cups for rent for a  
nominal sum, if desired.

A little child of Jas. Kona, a native  
man known as a rider of race horses,  
died in Kakaako last night of cholera  
infantum.

## Profitable Returns

Are what business men  
have a right to expect from  
well managed legitimate en-  
terprises. Hundreds fail  
where one succeeds, not from  
want of merit in the goods  
offered for sale, but because  
of a lack of the right kind of  
knowledge as to what their  
customers require.

With me, I study the con-  
ditions for a long time before  
investing my money in car-  
riages or harness, and when  
at last I find what is desired  
I scour the market of the  
United States from San Fran-  
cisco to the Atlantic ocean,  
if necessary, to get good  
goods, made by responsible  
houses, at figures that war-  
rant placing them before the  
public at a figure within reason  
and still allowing me a  
fair margin.



At present I have a hand-  
some line of—

Turnunder Delivery Wagons.

Just the thing for Hono-  
lulu's narrow streets.

My display of double and  
single Surrey Harness, as  
well as other styles, I con-  
sider the most complete in  
the city.

SCHUMAN'S  
Carriage and Harness Repository  
Fort St., Above Club Stables.

Agree With Us.

Give us a fair trial in comparison  
with other Breads and we are con-  
fident of your decision.

The GERMAN BAKERY  
833 FORT ST.  
TELEPHONE 677.

Change Your Grocer.

We have heard people say, "Oh,  
yes, I would like to deal with P. J.  
Voeller & Co. as everything is so nice  
there, and they are so accommodat-  
ing, but their prices seem high." We  
plead guilty to the first count and  
"not guilty" to the second. Our prices  
are lowest. Never do we ask more.

EPICURIAN BRAND  
Shrimp in Tomato Sauce  
15c Per Can For One Week.

Let us be your Grocer, you'll pay  
no more—possibly less—and you'll be  
sure of first qualities at all times.

P. J. VOELLER & Co.  
FORT & HOTEL ST.

Sausage Can't  
Be Very Good

—if its price has to be "cut" to  
sell it. Our Sausage isn't  
"high"—but it's easy to see  
why it sells more than others.  
It's so much richer, more deli-  
cious, that's why.

You won't mind paying our  
prices for GARES' SAUSAGE  
after you've once eaten some.

Central Meat Market.  
214 NUUANU ST.

YEE SING TAI.  
Matting, Wall Paper, Wicker Chairs and  
All Kinds of Furniture.  
CONTRACTOR AND BUILDER.  
Cabinet Making and Painting. Fort St.

## Tomorrow An Uncertainty!

Today we experience; Tomorrow never comes.  
An uncertainty is a dissatisfaction, leaving us doubt-  
ful as to the future, thereby causing hesitancy.  
Do not wait. Time passing rapidly. Get your shoes  
today and you will be content. Let us fit you with  
a pair of shoes, then all trouble, doubt and hesi-  
tancy vanish.

Shoes of all styles and prices, at

A. E. MURPHY & CO.

Island Orders Solicited.

205 Hotel St., Arlington Block.

—Opp. Elite Ice Cream Parlors—

WAR There will be none with us, except  
the battles of trade relative to high  
prices. The Flying Squadron, at the  
present, is no more alert in watching their opponents  
than we in cutting to the quick an exorbitant price.  
SPRI C WEATHER  
Is with us, and with it comes the desire to put on  
lighter clothing, and as a consequence when "step-  
ping out for just a minute" you forget the necessary  
precaution of protecting yourself against the cool  
evening winds—result, a headache and cold. We  
have a handsome wind protector in

Light Evening Capes.

LADIES' WHITE COLLARS AND CUFFS,  
TIES AND CRAVATS

Are some of the new novelties just received.

Temple of Fashion.

M. C. SILVA, Propr.

The Rubber Tire Wheel Company

The Only  
Successful  
Rubber Tire.

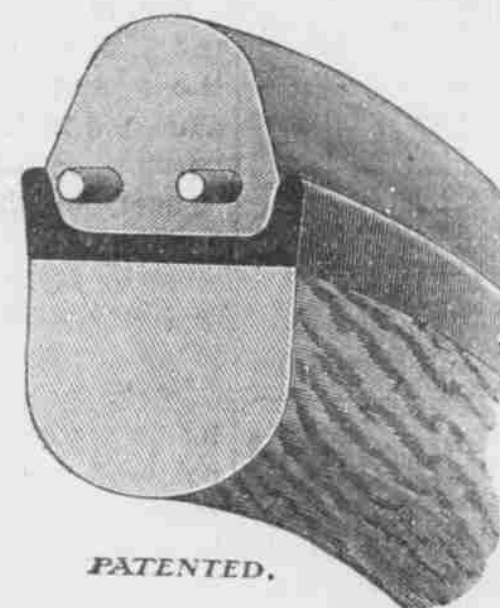

The Most Durable  
Roller-Bearing  
Axle.

PLANT AT THE HAWAIIAN CARRIAGE MANUFACTURING  
COMPANY, QUEEN STREET.

Economic, Easy, Efficient

Old Wheels Reset with Steel Channels, Rubber Tires,  
and Roller-Bearing Axles.

WILSON & WHITEHOUSE.

SOLE LICENSEES FOR THE HAWAIIAN ISLANDS.

Now Is the Time  
For Harness Buying

And for every use a harness can be put to—you'll find

COLLINS'

make tops every other make.

Best workmanship and ideas make it the BEST.

All that is best in DUSTERS, DRIVING AND RIDING  
WHIPS, HORSE BRUSHES AND COMBS and everything  
else can be found in this shop.

Look for the Dappled-Gray Horse in the window—that's  
the place.

C. R. COLLINS.

TELEPHONE 662.  
P. O. BOX 496.

King St., near Nuuanu St., Honolulu.

And at Hilo, Hawaii.

Daily Advertiser, 75 cents a Month



## LOCAL BREVITIES.

Bolled vegetable lunch today—H. B. Modern lace making—Mrs. Hanna's. Admiral Miller made a brief farewell call at the Executive Building yesterday.

The Rev. C. E. Winning will occupy the pulpit at the Methodist Episcopal Church tomorrow.

W. T. Monsarrat, Veterinary Surgeon and Dentist can be reached by telephones 161 or 626.

A fine homestead, in the best residence portion of Oakland, Cal., is for sale or rent. See ad.

Medeiros & Decker are in the business to make all persons equal as far as clothes are concerned.

Until further notice "The Kash" will close out all of the sailor suits for children at \$1.50 the suit.

George Ashley is very quiet about it, but there is a new little daughter in the family, born at San Jose, Cal.

This is the anniversary of the inauguration of George Washington as first President of the United States, 1789.

President and Mrs. Dole will give a dinner party on Tuesday night. Admiral Miller was to have been one of the guests.

Three rooms, kitchen, bath, unfurnished cottage, and furnished or unfurnished rooms can be had at 731 Fort street.

The one social event of next week most talked of at present is the Hawaiian Boat Club hop scheduled for Friday evening.

Aeromotors for any and all purposes and under all conditions are the subject of the Hawaiian Hardware Co.'s Timely Topics.

A special meeting of the Okaia Sugar Co., Ltd., will be held at the office of the Secretary at 10 a. m. Monday, May 24, 1898.

Eugene Gliberson, who made up the photographic group of business men, has slipped out of town after "biking" a number of people.

There will be no session of the Legislature today on account of the visit of members of both Houses to the leper settlement.

The Rev. G. L. Pearson will preach at Kamehameha tomorrow at 11 a. m. at the Peninsula in the afternoon and at Ewa in the evening.

There will be cricket practice this afternoon at British Commissioner Kenny's at 3 o'clock. All cricketers are invited to be present.

On Sunday evening at Central Union Church, Mr. Birnie will preach the first of a short series of sermons on "The Young Man and His Soul."

At the Y. M. C. A. meeting for men at 4 o'clock tomorrow afternoon, Rev. M. L. Berger, D. D., will deliver an address on "Egypt and the Nile."

A lucid treatment of Missionary Work in Japan was given before the Christian Workers meeting yesterday afternoon. Miss Julia Gulick read the paper.

About 40 people were aboard the special steamer for Molokai at 9 o'clock last evening. The party includes Legislators and members of the Board of Health.

Theo. H. Davies & Co. are agents for Nirvana Ceylon Tea. They publish the result of the analysis made by C. R. Blackett, Government chemist at Melbourne.

An American who will leave Hawaii to serve his country if opportunity is presented by war with Spain, advertises for letters from others of the same mind.

Arthur White, who was formerly in business here with Ed. Hopkins, returned to the Islands by the bark Albert. White has been away nearly three years.

This is Government salary day. The employees of the Board of Health received their coin yesterday for the reason that Clerk Wilcox went to Molokai last night.

The Government band will give concerts at Emma Square at 4:30 this afternoon and at Makee Island, Kapoli Park tomorrow afternoon.

The bark Nuuanu will sail from New York for Honolulu on or about July 5, if sufficient inducements offer. For particulars apply to C. Brewer & Co., or Chas. Brewer & Co., Boston.

The Hawaiian Mission Children's Society will meet this evening at the home of Chief Justice and Mrs. Judd, in Nuuanu Valley. There will be papers, addresses, music and a social.

Judge J. W. Davidson, an old kamaaina here returned on the Albert with his niece, Miss Clarke yesterday, after an absence of about three years, during which time he traveled the world over.

Mr. Miller, who so long had the cabinet maker's shop on Hotel street, has at last gotten off for the Klondike. He seemed to carry his many years lightly and had all the enthusiasm of a boy of 20.

Hopp & Co.'s ads are accepted literally because they are written literally and they ask that you compare their claims with the offerings. This week they offer Fibre Mats, something new, and cornice poles at inside figures.

An attempt was made yesterday afternoon to hold a meeting of the Hawaiian Tennis Association for the purpose of making arrangements for the coming tournament but not enough members to constitute a quorum arrived on the scene.

The canvass for names for the new directory under way. It will be complete in every respect. A house to house call will be made so that every name will be secured. For the purpose of facilitating the work it is requested that every assistance and information be given the canvassers.

Semola is a blend of choice cereals; is sweet, rich, nutritious; with the special merit that one does not tire of it.

Admiral Miller regrets that his unexpected sudden departure prevents him from calling to say good bye to his many friends in Honolulu.

L. L. Long, a San Francisco grain man who came here for his health a short time ago, will hasten back to San Francisco on the City of Peking on account of the serious aspect of the trouble between the United States and Spain.

### SAVING WEATHER BULLETIN.

"What Charlie Says"

DIAMOND HEAD. April 24, 1898.  
Weather, clear; wind, light N. E.

### BIG BARGAINS IN TOWELS

A good chance for housekeepers.

#### 7-SPECIAL BARGAINS-7

Each and all are extraordinary value. LINEN TOWELS, COTTON TOWELS, and TURKISH TOWELS.

All at reduced prices.

BARGAIN NO. 1—

Honey-comb Towels, 65 cts. a dozen.

BARGAIN NO. 2—

Honey-comb Towels, large size, \$1.15 a dozen.

BARGAIN NO. 3—

Cotton Damask Towels, good size, \$1.25 a dozen.

BARGAIN NO. 4—

Turkish Towels, good size, \$1.50 a dozen.

BARGAIN NO. 5—

Turkish Towels, large size, extra quality, \$2.40 per dozen.

BARGAIN NO. 6—

Pure Linen Towels, large size, extra quality, \$2.25 a dozen.

BARGAIN NO. 7—

Pure Linen Towels, extra size, drawn work, (special bargain), \$3.75 a dozen.

Sale begins today (Monday), April 25th.

PRICES FOR ONE WEEK ONLY.

### N. S. Sachs Dry Goods Co.

Limited.  
520 FORT STREET. : HONOLULU.

### JAS. F. MORGAN

33 QUEEN ST.

Telephone 74.

### STOCKS AND REAL ESTATE

FOR SALE.

\*\*\*

### Real Estate

FOR PRIVATE SALE.

1—LOT ON BERETANIA STREET,

near Thomas Square: 120 feet

on Beretania street; 290 feet

deep; 120 feet on Kinau street.

2—PREMISES OF MR. C. F. WOLFE,

Pikoi street, containing 1 76-

100 acres: Grounds planted

with Fruit Trees,—Oranges,

Limes, Peaches, Grapes, Pears,

Cherries, Etc. Water laid

throughout. An elegant piece

of property.

### Shares of Stock

INTER-ISLAND S. N. CO.

WILDER'S S. S. CO.

OAHU PLANTATION.

\*\*\*\*\*

### ART IN PRINTING.

There are probably a good many

people in town who are not aware that

we have one of the finest "up to date"

PRINTING OFFICES

in the country. It is a fact, however,

and from a very small beginning a

year ago, it has grown to such an extent

that we have been forced to

larger quarters, which we now occupy

at No. 113 1/2 B, Republic Avenue, ad-

joining our place of business, "The

Republic" Building, King Street.

Commercial and Society Printing

in the latest styles. Low prices, good

work and prompt service is our motto.

This branch of our business is under

the personal management of Mr. Geo.

S. Evans recently arrived from New

York city, and who has had large ex-

perience in this branch of business

in that city. Give us a trial. It will

pay you.

WALL, NICHOLS COMPANY.

YOUR MONEY SAVERS.

## Drop In

At any time you may happen to be

In the neighborhood of our handsome

Store, and get our clerks to show you our

Pretty assortment of novelties in foot covering.

Don't need Shoes just now? Perhaps

Not, but you will need them later on

And we want to supply them. Our

Prices are not "Less than cost of

Making," but they are fixed to allow

The smallest consistent margin.

## The Manufacturers' Shoe Co.

FORT STREET.

### HOT WEATHER

And thirst go together. A cool, refreshing glass of our Soda, flavored with the juice of ripe fruit, is a delightful remedy. It is a wholesome beverage, and enjoyed by adults and children alike. We guarantee a cure for the thirsty feeling—not a permanent cure, however—for a time.

\*\*\*\*\*

\*\*\*\*\*

\*\*\*\*\*

\*\*\*\*\*

\*\*\*\*\*

\*\*\*\*\*

\*\*\*\*\*

\*\*\*\*\*

\*\*\*\*\*

\*\*\*\*\*

\*\*\*\*\*

\*\*\*\*\*

\*\*\*\*\*

\*\*\*\*\*

\*\*\*\*\*

\*\*\*\*\*

\*\*\*\*\*

\*\*\*\*\*

\*\*\*\*\*

\*\*\*\*\*

\*\*\*\*\*

\*\*\*\*\*

\*\*\*\*\*

\*\*\*\*\*

\*\*\*\*\*

\*\*\*\*\*

\*\*\*\*\*

\*\*\*\*\*

\*\*\*\*\*

\*\*\*\*\*

\*\*\*\*\*

\*\*\*\*\*

\*\*\*\*\*

\*\*\*\*\*

\*\*\*\*\*

\*\*\*\*\*

\*\*\*\*\*

\*\*\*\*\*

\*\*\*\*\*

\*\*\*\*\*

\*\*\*\*\*

\*\*\*\*\*

\*\*\*\*\*

\*\*\*\*\*

\*\*\*\*\*

\*\*\*\*\*

\*\*\*\*\*

\*\*\*\*\*

\*\*\*\*\*

\*\*\*\*\*

\*\*\*\*\*

\*\*\*\*\*

\*\*\*\*\*

\*\*\*\*\*

\*\*\*\*\*

\*\*\*\*\*

\*\*\*\*\*

\*\*\*\*\*

\*\*\*\*\*

\*\*\*\*\*

\*\*\*\*\*

\*\*\*\*\*

\*\*\*\*\*

\*\*\*\*\*

\*\*\*\*\*

\*\*\*\*\*

\*\*\*\*\*

\*\*\*\*\*

\*\*\*\*\*

### EGAN'S

FORT STREET.

### SPECIALS For The Third Week

Of The Renovation Sale:

SPECIAL LINE OF FINE FRENCH

ORGANDIES.

5 yds. \$1.00.

EXTRA QUALITY MUSLIN

12 1/2 cts. per yard.

NEW DESIGN DIMITIES

10 cts. and 12 1/2 cts. per yard.

WHITE COTTON (36 in. wide)

18 yards for \$1.00.

BEST QUALITY FLANNELETTES

10 yards \$1.00.

GENT'S BLACK SOCKS.

10 cts. and upwards.

GENT'S COLLARS (good quality)

10 cts. each.

GENT'S NECKTIES 10 CTS.

Reduced from 25 cts. and 35 cts.

It will be worth your while to look

at the line of

GENT'S UNDERSHIRTS.

25 cts. and 35 cts.

EXTRA VALUE UNDERSHIRTS

45 cts.—a grand bargain.

LATEST NOVELTIES IN LADIES

SCARFS AND JEWEL BELTS.

LATEST SILK WAIST PATTERNS

At extremely low prices.

\*\*\*\*\*

\*\*\*\*\*

\*\*\*\*\*

\*\*\*\*\*

\*\*\*\*\*

\*\*\*\*\*

\*\*\*\*\*

\*\*\*\*\*

\*\*\*\*\*

\*\*\*\*\*

\*\*\*\*\*

\*\*\*\*\*

\*\*\*\*\*

\*\*\*\*\*

\*\*\*\*\*

\*\*\*\*\*

\*\*\*\*\*

\*\*\*\*\*

\*\*\*\*\*

\*\*\*\*\*

\*\*\*\*\*

\*\*\*\*\*

\*\*\*\*\*

\*\*\*\*\*

\*\*\*\*\*

\*\*\*\*\*

\*\*\*\*\*

\*\*\*\*\*

\*\*\*\*\*

\*\*\*\*\*

\*\*\*\*\*

\*\*\*\*\*

\*\*\*\*\*

\*\*\*\*\*

\*\*\*\*\*

\*\*\*\*\*

\*\*\*\*\*

\*\*\*\*\*

\*\*\*\*\*

\*\*\*\*\*

\*\*\*\*\*

\*\*\*\*\*

\*\*\*\*\*



**The Pacific Commercial Advertiser**  
Issued Every Morning, Except  
Sunday, by the  
HAWAIIAN GAZETTE COMPANY,  
Von Holt Block, King Street.  
C. G. BALLENTYNE,  
Manager.

## SHIPPING INTELLIGENCE.

## ARRIVALS.

Friday, April 29.  
Stmr. Kauai, Bruhn, from Kauai  
ports.  
Stmr. Mikahala, Thompson, from  
Kauai ports.  
Am. bk. Albert, Griffiths, from San  
Francisco.  
Am. schr. Carrier Dove, Uhlberg,  
from Newcastle.

## DEPARTURES.

Friday, April 29.  
Stmr. Mikahala, Thompson, for  
Kauai ports.  
Stmr. Kinau, Clarke, for Maui and  
Hawaii ports.  
U. S. S. Mohican, Book, for San  
Francisco.

## PASSENGERS.

**Arrivals.**  
From Kauai ports, per stmr. Mikahala, April 29—Miss J. Smith, Miss McCandless, Mrs. J. Noble and 4 on deck.  
From San Francisco, per bk. Albert, April 29—J. W. Davidson, Miss Clarke, A. White, J. W. Sanderson, A. D. Hill.  
From Kauai ports, per stmr. Kauai, April 9—F. Gay, wife and family and 33 on deck.

## Departures.

For Kauai ports, per stmr. Mikahala, April 29—Miss Charlotte Hall, G. N. Wilcox, A. St. M. Mackintosh, A. Garvie, D. Shanks, Arthur Mackintosh, H. von Holt, Mrs. C. B. Cooper, Mrs. Garstins, S. W. Wilcox, Mr. Langley, Mr. Walker, Judge Stanley, Harry Mist and Mrs. Gunn.

For Maui and Hawaii ports, per stmr. Kinau, April 29—Volcano: Geo. Ford, Miss Anna C. Edwards, Miss Mary F. Clark, Miss Cora D. Martin, W. B. Jones, C. H. Holwell, Miss Linda M. Curtis, Miss F. L. Chriss, Miss F. A. Bemis and Miss F. A. Clark, Hilo and way ports: C. L. Wright, Rev. Chizolechia, C. Hedemann, J. A. Scott, P. Peck, Captain Baker, G. Roedick, G. E. A. Thomas, S. Nowlein, J. W. Bergstrom, C. A. Galbraith, E. C. Macfarlane, Miss P. Judd, Mrs. Sheldon, Mrs. Wong Kau, Mrs. Wong, E. E. Richards, Mrs. Mah See, Mrs. Wong See, Kwong Hip Chong, C. H. Brown, V. M. Fulcher, Mrs. Rindhart, Miss Rindhart, Miss Lewis, Robert Wilhelm, Mrs. R. Sadler, J. M. Oat, A. Lindsay, Mr. Prescott and wife, A. H. Brewer.

## WHARF AND WAVE.

**DIAMOND HEAD SIGNAL STATION.** April 29, 10 p. m.—The weather is clear; wind, light, N.

The Waialeale and Kauai will not go out again until Monday.

The little steamer Iwa will sail on Monday for all Koolau ports.

The W. H. Dimond has hauled over to the railroad wharf. She may sail today.

The ship Iroquois could not get away yesterday on account of the lack of wind.

The Albert brought down from San Francisco a 14 ton boiler for the Oahu plantation.

The Aloha could still be seen off to the south west of Diamond Head at dusk yesterday.

The Mikahala took about 100 Japanese to various plantations on the island of Kauai yesterday.

The P. M. S. S. City of Peking is due from China and Japan today. The Peking flies the American flag.

The Jane L. Stanford is being rapidly laden. She took sugar from both the Mikahala and Kauai yesterday.

The Mikahala sailed for Kauai yesterday afternoon and will return Monday morning with a load of sugar.

The American bark Albert, Griffiths master, arrived in port and hauled alongside the Irmgard wharf early yesterday afternoon, 16 days from San Francisco with a cargo of 1,200 tons of general merchandise for H. Hackfeld & Co. Ltd.

The American schooner Carrier Dove, Whelberg master, arrived in port yesterday morning after a long and uneventful trip of 83 days from Newcastle, N. S. W., with a cargo of 1,161 tons of coal, for W. G. Irwin & Co. She hauled alongside Wilder's wharf.

## GIVE YOURSELF WEIGHT.

Don't give yourself away by accepting any of the inferior brands of beer. Be onto yourself and insist on getting "Rainier" and you will be looked upon as being intelligent and up-to-date, especially if you patronize the Favorite Saloon.

W. M. Cunningham, Proprietor of this well-known resort, has been in the business for many years, and is a connoisseur in liquors. His establishment is always orderly, and, with the services of his assistant, Mr. Thompson, customers are promptly supplied.

Wall, Nichols Co., have a whole lot of new popular music, including Albert Cunha's "Bay City March."

## Saw Much Racing.

Captain King, Minister of the Interior was in Sydney Easter week and says the people down there go in at that season for an exceptionally good time. Ordinarily upon the announcement of a horse race or a big cricket game or wheel meet, the shutters go up and "all hands" strike for the tracks and fields. The Saturday before Easter was a holiday with racing and of course Good Friday had been a big day. Sunday was quiet in town but lively in the country. Monday was a holiday again and there was racing on Tuesday. Captain King says that when he met Dave Crozier at Auckland that young man invited the traveler to attend racing and of course the invitation was accepted, though the sport was beginning to pall on the Minister. With Crozier the captain saw one good event—a running race with 15 starters.

At the 9:45 service tomorrow of the Second Congregation of St. Andrew's Cathedral, the choir of ladies and gentlemen will render special music. At the 6:30 o'clock service in the evening, the surprised choir of Hawaiians will render a full choral service. The Rev. Alex. Mackintosh will preach at both services.

Among the departures for Maui and Hawaii on the Kinau yesterday, were the following: C. L. Wight, C. Hedemann, J. A. Scott, P. Peck, G. Roedick, E. C. Macfarlane, Miss P. Judd, E. E. Richards, V. M. Fulcher, J. M. Oat, A. Lindsay, A. H. Brewer.

There was a sailor's soiree aboard the Western Monarch last night. It wound up with free fight in the dark. A knife was drawn. Two men are in jail on account of the affray.

Miss Juliette Smith returned from Kauai yesterday on the Mikahala.

## DIED.

**FALK**—In San Francisco, April 12, 1898, Ernestine, beloved wife of Philip Falk, and mother of Mrs. Gussie Schmidt, Mrs. J. P. Sargent, Ray G. and Charles J. Falk, a native of Germany, aged 62 years.

## FOR THE WAR.

A YOUNG AMERICAN WHO PROPOSES to join with his countrymen for service against Spain if such opportunity opens, would like to get into communication with others of the same mind. Please address "A B C," this office.

## FOR RENT.

3 ROOMS, KITCHEN, BATH, ETC. Cottage unfurnished. Furnished or unfurnished rooms. Apply at 731 FORT STREET.

FOR RENT OR FOR SALE IN OAKLAND CALIFORNIA.

A FINE HOMESTEAD IN THE best residence quarter, surrounded by an acre of ground; fine old palms, deciduous trees, etc. Address "H," 1206 Alice St., Oakland, Cal.

## NOTICE OF MEETING.

A special meeting of the shareholders of the Oohala Sugar Co., Ltd., will be held at the office of the undersigned at 10 a. m. Monday, 24 May, 1898.  
W. C. SPROULL,  
Secretary Oohala Sugar Co., Ltd.  
Honolulu, April 30, 1898.

## NOTICE TO PATRONS.

ON AND AFTER MAY 1st, THE undersigned will put on an additional wagon to accommodate the demand. Intending patrons will please telephone to 1013.

**STAR DAIRY CO., LTD.**  
Honolulu, April 29, 1898.

## HOME FOR NURSE.

A GOOD HOME FOR A SENSIBLE woman to do nursing and washing. Telephone 823.

## ROOMS AND BOARD.

FURNISHED ROOMS AND BOARD can be had at 225 Punchbowl street. White cook.  
W. S. FAIRMAN.

## SITUATION WANTED.

BY A YOUNG MAN; AN EXPERIENCED accountant. Position in Honolulu or immediate vicinity Preferred. Best recommendations.  
Apply, "G. H. J.,"  
Hawaiian Gazette Office.

## "Better Than New."

A customer's comment on a broken Bicycle frame after it had been repaired at

**The Honolulu Cyclery.**  
231 KING ST.

Because so many Bikes are too thin in Tube, JUST where strength is most wanted.  
Fittings and fittings in stock, are made to order by competent workmen for every make of machine now used in Honolulu.  
Established 1892.

## GOOD WORK ONLY.

## DOCTORS COULD NOT AGREE.

Mr. Thos. E. Webb, Wolverton, Canada, says:—"Mine was a case as to the nature of which the doctors could not agree, and it is perhaps under the circumstances not to be wondered at that they failed to cure me. My illness began some years ago. The first doctor whom I consulted said that my trouble was due to catarrh. I took his treatment but was getting worse. Then I went to another doctor, and he told me that my liver was out of order, and that I had indigestion, but he did me no good. Then I consulted another doctor who told me my stomach was all wrong and that I was in a bad shape—whilst latter I already realized. I took his treatment, but it did me no good, and then, as if my cup of misery was not already full I was attacked with acute rheumatism. How much I suffered, tongue cannot tell. I consulted still another doctor who told my friends that I would not survive a year. I then began using Dr. Williams' Pink Pills, but the doctor opposed it and I stopped. Some time after the doctor told me he could do nothing more for me, and then on the advice of a friend I again began taking Pink Pills. After a few weeks I could see that they were helping me, and I continued their use until I am again able to do a good day's work, and my misery has passed away." If I ever require medicine again it will be Dr. Williams' Pink Pills that I will resort to.

Dr. Williams' Pink Pills for Pale People contain in a condensed form all the elements necessary to give new life and richness to the blood and restore shattered nerves. They are an unfailing specific for such diseases as locomotor ataxia, partial paralysis, St. Vitus' dance, sciatica, neuralgia, rheumatism, nervous headache, palpitation of the heart, and the tired feeling resulting from nervous prostration; all diseases depending upon vitiated humors in the blood, such as scrofula, chronic erysipelas, etc. They are also a specific for troubles peculiar to females, such as suppressions, irregularities and all forms of weakness. In the case of men they effect a radical cure in all cases arising from mental worry, over-work or excesses of whatever nature.  
Sold by all dealers in medicine.

The bark Albert brought 17 head of mules, all in the very finest condition, for Paul Isenberg. They came in charge of the mate.

## W. T. MONSARRAT,

VETERINARY SURGEON AND DENTIST.

TELEPHONES 161 & 626.

CHAS. BREWER & CO.'S  
New York Line.

The Bark "Nuanu" will sail from New York to Honolulu on or about July 15, 1898.

If sufficient inducement offers. Advances made on shipments on liberal terms. For further particulars, address Messrs. CHAS. BREWER & CO., 27 Kilby Street, Boston or  
C. BREWER & CO., Ltd.,  
Honolulu Agents.

## Pioneer Building and Loan Association

THE REGULAR MONTHLY MEETING of the Pioneer Building and Loan Association will be held at the Chamber of Commerce on MONDAY EVENING, May 2, 1898, at 7:30 o'clock. Payments are required in gold.  
A. V. GEAR, Secretary.

## Monuments and Headstones.

The undersigned is prepared to do CEMETERY work of all kinds, and supply MONUMENTS and HEADSTONES of which he has a great variety of the latest and most artistic designs, and will also supply stone copings separately for surrounding cemetery lots.

Estimates given in Marble, Granite, Hawaiian Stone, etc.  
FRED. HARRISON.

## AT MRS. DICKSON'S OFFICE,

Woman's Exchange, you can have a good shampoo. Take your hair combs to be made into a switch, your soiled Panama or straw hats, gloves, ribbons, etc., to be cleaned; also dresses, sponged and pressed.

## NOTICE.

Choice Thoroughbred White Leghorn Eggs—suitable for hatching—for sale.  
C. F. HERRICK.  
P. O. Box 409.

## LESSONS ON CORNET.

The undersigned will give lessons on the Cornet to a limited number of pupils. Individual instruction. For terms apply to  
C. KREUTER,  
Music Dept. Wall, Nichols Co.

## Engrossing and Illuminating

DONE BY  
CHARLES K. HOPKINS.

All orders left at the Pacific Hardware Co.'s store will be promptly attended to.

## If your grocer

doesn't sell *Schilling's Best* tea, tell us his name, what kind you want (Japan, English Breakfast, Oolong, Ceylon, or Blend), and what size package you want. We'll see that you get it.

Don't send us any money. We don't sell at retail.

San Francisco

A. Schilling & Company

## Oceanic Steamship Company.

## TIME TABLE:

The Fine Passenger Steamers of This Line Will Arrive at and Leave This Port as Hereunder:

## FROM SAN FRANCISCO:

ZEALANDIA ..... MAY 11  
MARIPOSA ..... MAY 25  
ZEALANDIA ..... JUNE 8  
MOANA ..... JUNE 22

## FOR SAN FRANCISCO:

ZEALANDIA ..... MAY 17  
MOANA ..... MAY 26  
ZEALANDIA ..... JUNE 14  
ALAMEDA ..... JUNE 23

In connection with the sailing of the above steamers, the Agents are prepared to issue, to intending passengers, coupon through tickets by any railroad from San Francisco, to all points in the United States, and from New York by any steamship line to all European ports.

For further particulars apply to

## WM. G. IRWIN &amp; Co.

General Agents Oceanic S. S. Co.

## Pacific Mail Steamship Co.

## Occidental &amp; Oriental Steamship Co.

Steamers of the above companies will call at Honolulu and leave this port on or about the dates below mentioned.

## FOR JAPAN AND CHINA:

RIO DE JANEIRO ..... May 7  
GAELIC ..... May 17  
CITY OF PEKING ..... May 26  
DORIC ..... June 4  
CHINA ..... June 15  
BELGIC ..... June 25  
PERU ..... July 5  
COPTIC ..... July 14  
RIO DE JANEIRO ..... July 23

## FOR SAN FRANCISCO:

CITY OF PEKING ..... Apr. 30  
DORIC ..... May 10  
CHINA ..... May 20  
BELGIC ..... May 31  
PERU ..... June 10  
COPTIC ..... June 19  
RIO DE JANEIRO ..... June 28  
GAELIC ..... July 8  
CITY OF PEKING ..... July 17

For freight and passage and all general information, apply to

## H. Hackfeld &amp; Co., Ltd.

—AGENTS.—

## A Jury of Ladies

A jury of ladies sitting in judgment upon those new gloves we have just received would be most apt to render the following verdict: "Guilty of being just too sweet for anything." That would be rather a "gushy" way of putting it, but it would be none the less accurate. Call in and inspect them. We have them in TANS and MODES, PLAIN WHITE and WHITE WITH BLACK STITCHING.

We really believe that we have the most complete line of

## Lace Insertions

(20 Inches Wide)

And range in price from \$1 to \$4 a yard.

We also have some especially notable offerings in

## Fancy Tucking.

## B. F. EHLERS &amp; CO.

Fort Street.

## I. O. O. F.

The Annual Basket Picnic and Ball of the I. O. O. F., will be held at Sans Souci, on Saturday evening, April 30th. All members of the order and their families, as well as visiting Brothers are cordially invited to attend. Buses will connect with half-hour cars from 9 a. m. until 4:30 p. m., and with quarter hour cars after 6:30 p. m. to carry passengers to grounds. Badges can be secured from  
H. H. WILLIAMS, D. D. G. S.  
Chairman.  
THEO. P. SEVERIN, V. G.,  
Secretary.

No one will be admitted on the floor without a badge.

## ELECTION OF OFFICERS.

PALAMA CO-OPERATIVE GROCERY COMPANY, LTD.

AT A MEETING OF THE ABOVE Company held April 26, 1898, the following Officers were elected to serve for one year:

T. B. Murray ..... President  
Wm. McCandless ..... Vice-President  
George Cavenagh ..... Secretary  
W. Wolters ..... Treasurer  
C. B. Gray ..... Auditor  
H. Cannon ..... Manager  
F. J. Testa, Director, with the elected Officers shall constitute the Board of Directors.  
GEO. CANENAGH,  
Secretary.  
Honolulu, April 27, 1898.

Canadian-Aus-  
Steamship ty!

Steamers of the above line come in connection with the PACIFIC RAILWAY CO., between Vancouver, B. C., and N. S. W., and calling at Victoria, Honolulu, Suva (Fiji), and Wellington, N. Z., are

**DUE AT HONOLULU**  
On or about the dates below stated, viz:

FROM VANCOUVER AND VICTORIA, B.C.  
For Suva, Wellington (N.Z.), and Sydney:

WARRIMOO ..... MAY 13  
AORANGI ..... JUNE 10  
MIOVERA ..... JULY 8  
WARRIMOO ..... AUG. 5  
AORANGI ..... SEPT. 2  
MIOVERA ..... SEPT. 30  
WARRIMOO ..... OCT. 23  
AORANGI ..... NOV. 25  
MIOVERA ..... DEC. 25

FROM SYDNEY, WELLINGTON (N.Z.), & SUVA  
For Victoria and Vancouver (B.C.):

AORANGI ..... MAY 11  
WARRIMOO ..... JUNE 8  
WARRIMOO ..... JULY 6  
AORANGI ..... AUG. 3  
MIOVERA ..... AUG. 31  
WARRIMOO ..... SEPT. 28  
AORANGI ..... OCT. 26  
MIOVERA ..... NOV. 23  
WARRIMOO ..... DEC. 21

Through tickets issued from Honolulu to Canada, United States and Europe.

For Freight and Passage and all general information, apply to

THEO. H. DAVIES & CO., Ltd., Gen. Agts.

## AUSTRALASIAN UNITED STEAM NAVIGATION COMPANY, LTD.

FOR DYEA, JUNEAU CITY, and FORT WRANGEL.  
(For the Klondike Gold Fields.)  
Calling at VICTORIA and VANCOUVER, B. C., En Route.

The New Steel Steamship

**"PAROO,"**  
2664 Tons, Will leave Honolulu for the above ports on

THURSDAY, APRIL 28,  
For Freight or Passage, apply to

THEO. H. DAVIES & CO., LTD.  
Agents.

## Decoration Day

IS NEAR AT HAND.

HAWAIIAN STONE MONUMENTS and CEMETERY WORK (in detail). CARVING AND INSCRIPTIONS. Prompt and careful service given to all work entrusted to me.  
ARTHUR HARRISON,  
Queen and Fort Streets,  
With Washington Feed Co.

## FOR RENT.

Elegant Offices in the  
**NEW PROGRESS BLOCK.**  
Single or en suite.

Electric Elevator, Electric Lights; Lavatory and Sanitary arrangements complete.

Rooms ready for occupancy by the 15th of April.

For terms, inquire of

**BRUCE WARING & CO.**  
4859-11 314 Fort Street.

Best Residence Lots  
For Sale.

There are only Eight Lots situated on mauka side of Beretania Street, and lying between Punchbowl Street and Miller Lane for sale. It is the only center premises for sale convenient for residences in market.

Prices are very reasonable. For terms and further particulars apply to

W. C. ACHI & CO.,  
Real Estate Brokers.  
Honolulu, February 16th, 1898.  
4845-11

## FOR LEASE.

For a long term of years, the desirable Paoa pasture land, comprising about 400 acres. About 12 acres fenced; level land on good road, suitable for dairy houses and sorghum. The only ranch land adjoining Honolulu. Reasonable terms to responsible party. Inspection solicited. Inquire of  
C. W. BOOTH, Tel. 494.

**L. KONG FEE.**  
**MERCHANT: TAILOR.**  
623 1/2 Fort St., Opp. Club Stables.

FINE SUITS TO ORDER AT REASONABLE RATES.  
Suits cleaned and repaired. Satisfaction guaranteed.