

VOL. III

HONOLULU, HAWAIIAN ISLANDS, WEDNESDAY EVENING JUNE 3, 1896

982



Scrofula

The Worst Case the Doctors Ever Saw

Hood's Sarsaparilla Perfectly Cured

Scrofula is a disease which attacks the system...

Hood's Sarsaparilla Cures

They Were All Healed.

Hobson Drug Company

Wholesale Agents

CARRIAGE MANUFACTURERS

W. W. WRIGHT

PLUMBERS AND TIN-SMITHS

KEMMELT & CO.

SALOONS

MECHANICS

BUSINESS AGENT

REAL ESTATE AND GENERAL BUSINESS

J. S. WALKER

General Agent for Hawaiian Islands

Royal Insurance Company

Alliance Assurance Company

Alliance Marine and General Assurance Company

Sun Insurance Company of San Francisco

Wilhelms of Madgeburg Insurance Company

North Western Mutual Life Insurance Company

Scottish Union and Insurance Co.

Room 12, Spreckels' Block, Honolulu

A JAPANESE DRUGGIST

APPLICATION IS MADE FOR A PERMIT TO ESTABLISH ONE HERE.

Matter Deferred—Vaccination Sought

On account of the sailing of the Australia this afternoon...

An application from Isaburo Hirano for a license to open a drug store in Honolulu was read...

President Emerson said it was necessary to fill the vacancy on the Board of Examiners of leprosy...

It was thought that before school closes was the time to take steps in the direction suggested...

Mr. Brown obtained a leave of absence on account of his departure tomorrow for Massachusetts...

THE LADIES. The pleasant effect and perfect safety with which ladies may use the California liquid laxative...

M. PHILLIPS & CO. Wholesale Importers and Jobbers of AMERICAN & EUROPEAN DRY GOODS.

Unable to Work! NO APPETITE! COULD NOT SLEEP!

Ayer's Sarsaparilla COMPLETELY CURED HIM.

Mr. T. J. Clune, of Walkerville, Adelaide, South Australia, writes:



"Six years ago, I had an attack of indigestion and liver complaint that lasted for weeks...

After taking several bottles of Ayer's Sarsaparilla, I was completely cured...

AYER'S SARSAPARILLA Sold Everywhere.

AYER'S PILLS, Mild but Effective.

HOLLISTER DRUG CO., WHOLESALE AGENTS.

Your Eyes

—may be all right as far you know—yet our searching examination may reveal some defect in the sight which, if not corrected, may cause you serious trouble later on.

FREE OF CHARGE

H. F. WICHMAN, Scientific Optician.

FORT STREET.

HOW THEY WILL PLAY.

Corrected Schedule of League Ball Games for 1896.

The following is the official schedule of games to be played by the Hawaii Base Ball League this season...

May 23 Stars vs. Honolulu.

June 6, 1st Regt. vs. Kanehahua.

June 13, Kams. vs. Stars.

June 20, Honolulu vs. 1st Regt.

June 27, 1st Regt. vs. Stars.

July 4, Kams. vs. Honolulu.

July 11, Stars vs. Honolulu.

July 18, 1st Regt. vs. Kanehahua.

July 25, Kams. vs. Stars.

Aug. 1, Honolulu vs. 1st Regt.

Aug. 8, 1st Regt. vs. Stars.

Aug. 15, Kams. vs. Honolulu.

Aug. 22, Stars vs. Honolulu.

Aug. 29, 1st Regt. vs. Kams.

Sept. 5, Kams. vs. Stars.

Sept. 12, Honolulu vs. 1st Regt.

Sept. 19, Stars vs. 1st Regt.

Sept. 26, Honolulu vs. Kams.

SENATE AFTERNOON.

The Senate did very little Tuesday afternoon.

Mr. Damon, for the Executive, reported further on the funding and loan measures.

He said he had been deemed advisable to ask for the \$2,000,000 on a basis of 2 per cent discount and 1 per cent commissions.

MADE HER FEEL WELL. The physician was surprised to find the head of the household at the door with a shotgun.

"Why, what's the matter?" stammered the doctor.

"That there Seattle beer you give my wife, she says is makin' her feel like a new woman, and I want you to understand that my poor woman has been growin' in this house. Fast thing I know she'll be makin' speeches."

For sale at Criterion saloon.

Y. F. S. C. E. The initial convocation of the Y. F. S. C. E. will meet in Central Union church at 7:30 this evening.

Rev. C. W. Hill of Hilo will address the body on the subject: "Possibilities of Christian Endeavor Work in the Islands."

Others will make remarks and there will be other exercises.

Some time ago I was taken sick with a cramp in the stomach, followed by diarrhoea. I took a couple of doses of Chamberlain's Colic, Cholera and Diarrhoea Remedy and was immediately relieved.

I consider it the best medicine in the market for all such complaints. I have sold the remedy to others and every one who uses it speaks highly of it.

J. W. STRICKLER, Valley Center, Cal. For sale by all druggists and dealers.

Benson, Smith & Co., agents for H. I.

A HINT TO SAN FRAN. (Chronicle.) The Pacific Mail Company will do well to make a livelier bid for the Honolulu business.

The tramp steamers and the line from Seattle ought not to get any business, for two steamers a month by the Pacific Mail and one by the Oceanic Company ought to furnish all demands for transportation to this coast.

Every business has strong competition, and nothing but good advertising will give you your share of the trade.

—Brookton Times.

ELITE ICE CREAM PARLORS. Candy Factory, Cake Bakery, FINE ICE CREAM, HOT PASTRY, COFFEE, TEA, CHOCOLATE, ISLAND CURIOS.

Our Establishment is the Finest in the City. Call and see us. Open till 11 p. m.

SEASIDE RESORT. A short distance from the Bridge, Waikiki. Tourists and others will find it to their advantage to visit the above resort, as they will meet with every accommodation that comfort requires.

MRS. THOMAS WRIGHT, Proprietress.

HOTEL PARTY.

The Hawaiian Hotel was the scene of music and gaiety Tuesday evening in honor of the outgoing passengers by the Australia.

Host Lucas served a fine French dinner from 6 to 8. From 7:30 to 9:30 the band played on the grounds.

At 10 o'clock a string orchestra was called in and dancing began on the lawn. This was kept up until midnight.

THE KEE. And gracefulness with which judges of a par excellence beer take to the world's famous Pabst-Milwaukee beer is attested by the daily increase of patronage at the Royal, Pacific and Cosmopolitan saloons.

Sold at the same price as other beers. Medals at the World's Fair and Munich International Exposition.

ROUGH ON ATTORNEYS. "I have here," said the agent, "a little book that will show you how to be your own lawyer."

"If I could only be somebody else's lawyer," said the man with the blue beard that was gray at the roots, "I might buy it. But what is the use of a man to learn how to rob himself?"

—Indianapolis Journal.

Ripans Tabules

Stella M. Godfrey, writing from Hoffman, N. C., under date of June 12, 1895, says: "My sister has used your medicine for several years, and after having your Tabules recommended and given them a trial, she speaks in the highest terms of them, and says that they cannot be excelled in keeping the system well regulated."

Her name is (Miss) Katherine Godfrey, Post-Office Hoffman, N. C."

Ripans Tabules are sold by druggists, or by mail if the price 50 cents a box is sent to the Ripans Chemical Company, No. 10 Spruce St., New York. Sample visit 10 cents.

WILDER & CO. (Established 1874.) Estate of G. WILDER - W. C. WILDER.

Importers and Dealers in Lumber and Coal

Building Materials

DOORS, SASH, BLINDS,

Builders' Hardware,

Paints, Oils, Glass,

WALL PAPER, ETC.

Cor. Fort and Queen Streets, HONOLULU, H. I.

J. T. LUND, ELECTROPLATER, 128 and 130 FORT STREET, Opp. Club Stables. Tele. 107.

Are You

Sure your heart is sound? If not, investigate. Send for Dr. Miles' late book on the Heart and Its Disorders, it is free and will be sent to any address upon request.

Address, Dr. Miles Medical Co., Elkhart, Ind.

Dr. Miles' New Heart Cure is sold druggists on positive guarantee, for benefits, or money refunded.

Dr. Miles' Heart Cure Restores Health.

THE CRUST OF A PIE. Must be right or the pie is a failure. It matters not whether your horse is a draught or carriage animal, if his feed is not right he will refuse to do the work required of him.

Clipped Oats Extra Wheat Hay No Better, Fresher Stock in Honolulu.

WASHINGTON FEED CO. Fort St. n. Queen. Tel. 422.

JOHN PHILLIPS, Plumber, HOTEL STREET, NEAR FORT. Telephone, 302.

WEEKLY STAR, \$4 per year.

FOR SALE: 1 No. 2 Zimmerman's Fruit Evaporator, suitable for drying fruits or vegetables.

1 All Brass Ship's Pump in good order.

1 30-Light "Combination" Gas Machine, complete and in perfect order, for lighting residence or supplying gas for laboratory work.

APPLY TO JOHN EMMELUTH & CO. 4 Merchant Street.

New Goods. New Designs in Art Furniture. ART CABINETS, BEDSTEADS, TABLES, CHAIRS, SOFAS, Etc., Etc.

Fine Silk Goods. Ladies' Silk Shirts, Sashes and Handkerchiefs.

Porcelain & Lacquer Ware. Excellent Stock of Toys and other Seasonable Goods.

S. OZAKI. 314 KING STREET, COR. SMITH

THE PEERLESS PRESERVING PAINT COMPANY, 608 Merchant St., HONOLULU, H. I.

Warranted all we claim for it. We claim there is no Paint Manufactured equal to it as a preservative for either wood or metal.

Warranted not to scale, crack, run or evaporate.

ALL CONTRACTS Taken by it will be fully guaranteed. Estimations made and Estimates given free of charge. One generous coat of Peerless equal to three coats of any other kind of Paint. References given by application to our office. Telephone 139

FOR SALE:

1 No. 2 Zimmerman's Fruit Evaporator, suitable for drying fruits or vegetables.

1 All Brass Ship's Pump in good order.

1 30-Light "Combination" Gas Machine, complete and in perfect order, for lighting residence or supplying gas for laboratory work.

APPLY TO JOHN EMMELUTH & CO. 4 Merchant Street.

New Goods. New Designs in Art Furniture. ART CABINETS, BEDSTEADS, TABLES, CHAIRS, SOFAS, Etc., Etc.

Fine Silk Goods. Ladies' Silk Shirts, Sashes and Handkerchiefs.

Porcelain & Lacquer Ware. Excellent Stock of Toys and other Seasonable Goods.

S. OZAKI. 314 KING STREET, COR. SMITH

CASTLE & COOKE LIMITED.

IMPORTERS OF Hardware and General Merchandise.

We wish to call your attention to the

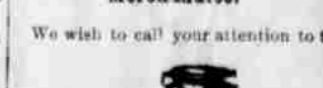

DIETZ' Tubular Driving Lamp

This Lamp can be attached to the SIDE OF DASH by using DIETZ' NEW DRIVING LAMP HOLDER, making it one of the most convenient lamps in existence.



These RAIN GAUGES have an 8 in. funnel, with graduated glass measure, they are made of copper, last forever and just the thing used by every plantation on these islands as well as every resident.

Warranted all we claim for it. We claim there is no Paint Manufactured equal to it as a preservative for either wood or metal.

Warranted not to scale, crack, run or evaporate.

ALL CONTRACTS Taken by it will be fully guaranteed. Estimations made and Estimates given free of charge. One generous coat of Peerless equal to three coats of any other kind of Paint. References given by application to our office. Telephone 139

Castle & Cooke Ld. Importers, Hardware and General Merchandise. ESTABLISHED 1858.

BISHOP & CO., Bankers, TRANSACT A GENERAL BANKING AND EXCHANGE BUSINESS.

Commercial and Traveler's Letters of Credit issued, available in all the principal cities of the world.

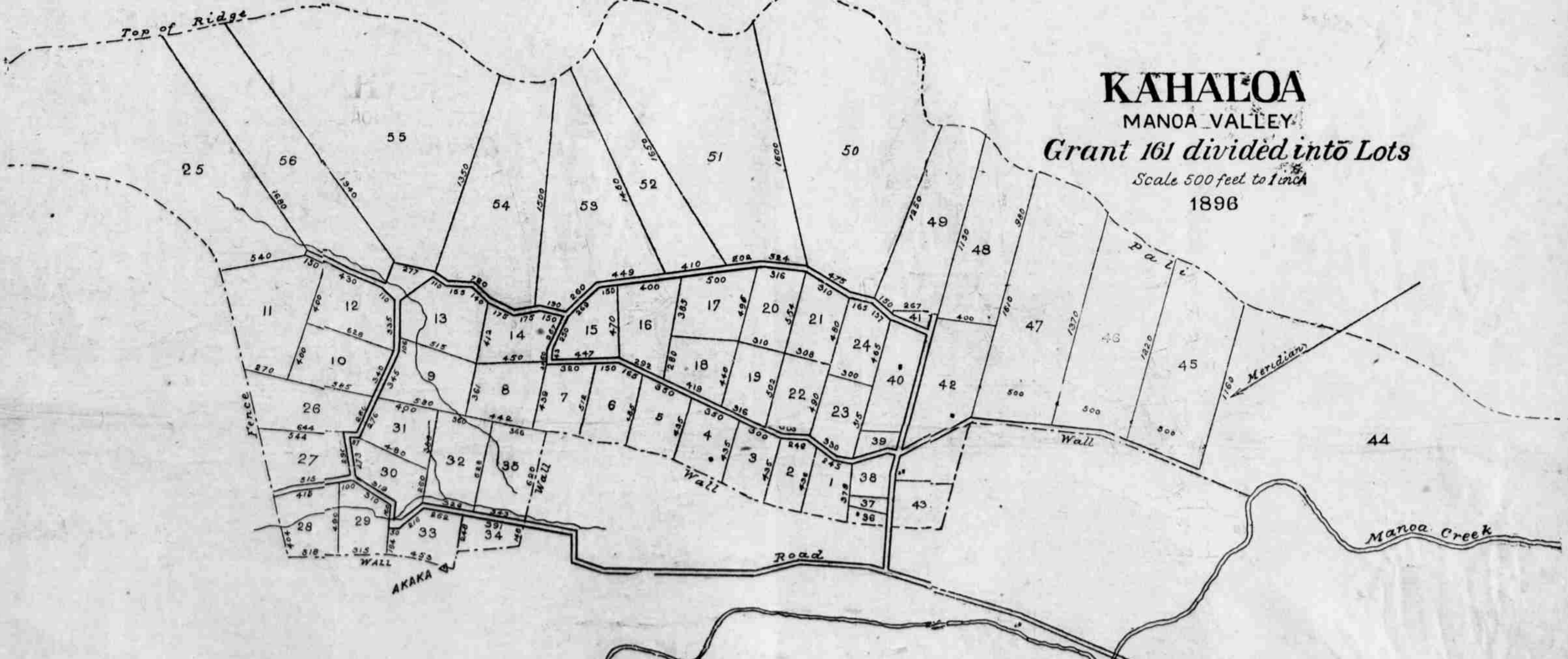

KAHALO'A MANOA VALLEY

Grant 161 divided into Lots

Scale 500 feet to 1 inch

1896

AUCTION SALE OF REAL ESTATE IN MANOA VALLEY.

On WEDNESDAY, JULY 8th, at 12 o'clock noon, at my Salesroom, Queen Street, I will sell at Public Auction 48 PARCELS OF LAND IN MANOA VALLEY

Comprising 3 to 38 Acres Each. For further particulars apply to

JAS. F. MORGAN, Auctioneer.

REAL ESTATE
BROKERAGE, INSURANCE,
NOTARY PUBLIC.

C. D. CHASE,
Sole Deposit Building,
406 FORT ST. Telephone 256

For Rent
RESIDENCE OF HENRY H. HUGHES
1001 HAWAIIAN BLVD. Phone 1001
Will rent same furnished or unfurnished.
Apply to Mr. H. H. Hughes, 1001 Hawaiian Blvd., Honolulu, T. H.

PRICE OF LOTS
\$250 DOLLARS.
\$10 Cash, and the balance at \$15 per month until paid.

Notice
I have several very desirable pieces of property in and out of town that will pay investors to look at.

C. D. CHASE,
SAFE DEPOSIT BUILDING,
406 FORT STREET.

DAINTY WOMEN
Like to have their surroundings in keeping with their tastes, and are as particular about the...

WALL PAPER
Being in harmony with the house as they are about the food they eat. The same fastidious they are the better they will be pleased for our stock is a delight to every stockholder.

LEWERS & COOK.

YOUR Drug Store.
We want you to consider this your drug store. We want you to feel perfectly at home. Our telephone is at your service. Our is a central place to visit for all the things you need. We're cheerful—their without adding because placed there for you.

People admire push and enterprise. They like to witness the advancement of any legitimate business. Like to deal with those who have energy and push and try to serve their customers better than anyone else.

And that is what we are doing—serving you just as well as we know how. We're the little, every day savings you make that count. Nickels and dimes that slip through the fingers of accident. We're saving our customers pennies and cents on every purchase. Sometimes 100 per cent savings on a dollar purchase—25 per cent on a \$100 purchase—50 per cent on a \$1000 purchase. We're saving you money all day long. Monday, Tuesday, Wednesday, Thursday, Friday, Saturday, Sunday.

Hebron Drug Co.

REVOLUTION... In the Dry Goods Trade.
THE TRADE PUZZLED, THE PUBLIC PLEASED.

White Muslin Dresses 15 yards for \$1.00.
Superior Flannelottes 12 yards for \$1.00.
Ribbons in all colors, 5 yards for 25c.
Straw hats at 25c. Only a few more left.
Linen Table Napkins, large size, \$2.00 per dozen, worth just double that amount.
Damas Table Cloths at 40c per yard.
Lace Curtains, 5 yards long, at \$1.25, usually sold by other dealers at \$2.50.
Bedspreads and Sheetings in all qualities.
Pure Linen Hemstitched Handkerchiefs in all sizes and qualities.
Flowers and Feathers in every conceivable color.
Laces and Embroideries in endless variety.

L. B. KERR, —STREET.

ROYAL Baking Powder
ABSOLUTELY PURE

HIGHEST OF ALL IN LEARNING POWER—LATEST U. S. GOV. REPORT

DEATH OF MRS. HARTWELL
Mrs. Hartwell died at her home in Honolulu, T. H., on June 1, 1920, at the age of 82 years. She was born in New York, N. Y., and was the widow of John Hartwell, who died in 1885. She was a member of the Methodist Episcopal Church and was a devoted wife and mother. She is survived by several children and grandchildren.

Continuation OF AUCTION SALE OF FINE JAPANESE GOODS.
On Thursday, June 4th, at 10 o'clock a. m., at the Honolulu Block Hotel, I will sell at Public Auction an assortment of Japanese Art Ware just received from the Japanese Consulate in Honolulu. The assortment includes a large number of valuable pieces of Japanese pottery, including tea caddies, vases, and other decorative objects. The goods are of high quality and are being sold at a special price. For further information, apply to the auctioneer, Jas. F. Morgan, at the Honolulu Block Hotel.

DR. PRICE'S CREAM BAKING POWDER
NEVER SPOOLS A MIX

DR. PRICE'S CREAM BAKING POWDER
NEVER SPOOLS A MIX

DR. PRICE'S CREAM BAKING POWDER
NEVER SPOOLS A MIX

ROYAL Baking Powder
ABSOLUTELY PURE

HIGHEST OF ALL IN LEARNING POWER—LATEST U. S. GOV. REPORT

DEATH OF MRS. HARTWELL
Mrs. Hartwell died at her home in Honolulu, T. H., on June 1, 1920, at the age of 82 years. She was born in New York, N. Y., and was the widow of John Hartwell, who died in 1885. She was a member of the Methodist Episcopal Church and was a devoted wife and mother. She is survived by several children and grandchildren.

Continuation OF AUCTION SALE OF FINE JAPANESE GOODS.
On Thursday, June 4th, at 10 o'clock a. m., at the Honolulu Block Hotel, I will sell at Public Auction an assortment of Japanese Art Ware just received from the Japanese Consulate in Honolulu. The assortment includes a large number of valuable pieces of Japanese pottery, including tea caddies, vases, and other decorative objects. The goods are of high quality and are being sold at a special price. For further information, apply to the auctioneer, Jas. F. Morgan, at the Honolulu Block Hotel.

DR. PRICE'S CREAM BAKING POWDER
NEVER SPOOLS A MIX

DR. PRICE'S CREAM BAKING POWDER
NEVER SPOOLS A MIX

DR. PRICE'S CREAM BAKING POWDER
NEVER SPOOLS A MIX

ROYAL Baking Powder
ABSOLUTELY PURE

HIGHEST OF ALL IN LEARNING POWER—LATEST U. S. GOV. REPORT

DEATH OF MRS. HARTWELL
Mrs. Hartwell died at her home in Honolulu, T. H., on June 1, 1920, at the age of 82 years. She was born in New York, N. Y., and was the widow of John Hartwell, who died in 1885. She was a member of the Methodist Episcopal Church and was a devoted wife and mother. She is survived by several children and grandchildren.

Continuation OF AUCTION SALE OF FINE JAPANESE GOODS.
On Thursday, June 4th, at 10 o'clock a. m., at the Honolulu Block Hotel, I will sell at Public Auction an assortment of Japanese Art Ware just received from the Japanese Consulate in Honolulu. The assortment includes a large number of valuable pieces of Japanese pottery, including tea caddies, vases, and other decorative objects. The goods are of high quality and are being sold at a special price. For further information, apply to the auctioneer, Jas. F. Morgan, at the Honolulu Block Hotel.

DR. PRICE'S CREAM BAKING POWDER
NEVER SPOOLS A MIX

DR. PRICE'S CREAM BAKING POWDER
NEVER SPOOLS A MIX

DR. PRICE'S CREAM BAKING POWDER
NEVER SPOOLS A MIX

ROYAL Baking Powder
ABSOLUTELY PURE

HIGHEST OF ALL IN LEARNING POWER—LATEST U. S. GOV. REPORT

DEATH OF MRS. HARTWELL
Mrs. Hartwell died at her home in Honolulu, T. H., on June 1, 1920, at the age of 82 years. She was born in New York, N. Y., and was the widow of John Hartwell, who died in 1885. She was a member of the Methodist Episcopal Church and was a devoted wife and mother. She is survived by several children and grandchildren.

Continuation OF AUCTION SALE OF FINE JAPANESE GOODS.
On Thursday, June 4th, at 10 o'clock a. m., at the Honolulu Block Hotel, I will sell at Public Auction an assortment of Japanese Art Ware just received from the Japanese Consulate in Honolulu. The assortment includes a large number of valuable pieces of Japanese pottery, including tea caddies, vases, and other decorative objects. The goods are of high quality and are being sold at a special price. For further information, apply to the auctioneer, Jas. F. Morgan, at the Honolulu Block Hotel.

DR. PRICE'S CREAM BAKING POWDER
NEVER SPOOLS A MIX

DR. PRICE'S CREAM BAKING POWDER
NEVER SPOOLS A MIX

DR. PRICE'S CREAM BAKING POWDER
NEVER SPOOLS A MIX

Hawaiian Circus
Next Performance Thursday Night, June 4th

HONOLULU BOAT
HONOLULU BOAT

HONOLULU BOAT
HONOLULU BOAT

Wanted
Fifteen Portuguese with families of 6 to 12, or single, for plantation. Apply to W. G. Jewin & Co., Ltd., for terms and nature of employment. 921-4

Never Wear Out
Hawaiian Circus

Pacific Mail Steamship Co.
General & Special Steamship Co.
For Yokohama and Hongkong
For San Francisco
For New York

THE TOP ROLLS UP
PRICE ROLLS DOWN!
That's the way with our Roller Top Desks.
\$22.50
Selected Oak,
HOPP & CO.
Furniture Dealers,
GENERAL MARKET,
Wm. G. Irwin & Co., Ltd.
HAWAIIAN NEWS CO., LTD.
OFFY FEED STORE,
Way, Grain and Feed

CITY FURNITURE STORE,
NEW GOODS
Groceries, Provisions and Feed.
Oahu Lumber & Building Company
Insurance Company of North America.
H. LONE, Agent for the Hawaiian Islands.
NEW GOODS.
Japanese Silks and Crepe Goods.
MURATA & CO.,
VALVOLINE OILS
HONOLULU IRON WORKS CO.,
JOHN NOTT.
Wrought Steel Ranges, Chilled Iron Cooking Stoves.
Plumbing, Tin, Copper and Sheet Iron Work.
ENTERPRISE - PLANING - MILL.
WOOD AND COAL.

ODD SPOKES.
The Company known through California FIG SYRUP CO.
SPECIALS FOR THE COMING WEEK.
E. W. JORDAN,
HOBSON DRUG CO.
Y. MAN SING,
CORNERS?
WASSMUTH'S CORN RINGS.
YOU HAD BETTER HURRY.
TWENTY PIECES 30c.
Iwakami.
CLAUS SPROCKELS & CO.
A. J. DERBY, D.D.S.
H. HACKFELD & CO.
DRY GOODS.
TAILOR'S GOODS.
A LARGE VARIETY OF SADDLES.
ZINC, LEAD, Plain Galvanized Iron, Railroad Iron, etc.
STERLING,
WOOD AND COAL.

Wm. G. Irwin & Co.,
Commission Agents,
OCEANIC STEAMSHIP COMPANY
CHAS. HUSTACE,
Groceries and Provisions.
C. BREWER & CO., LTD.
GEO. H. HUDDY,
Dentist.
H. MAY & CO.,
Wholesale and Retail.
CROCCERS
HONOLULU IRON WORKS.
Pacific Brass Foundry
H. HACKFELD & CO.,
Commission Merchants
Agents
JAS. F. MORGAN,
Auctioneer and Stock Broker.
MERCHANT TAILOR,
W. W. AIAHA,
FINE SUITINGS, Scotch and American Goods.
New Restaurant.
WING WO TAI & COMPANY,
LATE INSURANCE CO.
ATLAS ASSURANCE COMPANY.

Wm. G. Irwin & Co.,
Commission Agents,
OCEANIC STEAMSHIP COMPANY
CHAS. HUSTACE,
Groceries and Provisions.
C. BREWER & CO., LTD.
GEO. H. HUDDY,
Dentist.
H. MAY & CO.,
Wholesale and Retail.
CROCCERS
HONOLULU IRON WORKS.
Pacific Brass Foundry
H. HACKFELD & CO.,
Commission Merchants
Agents
JAS. F. MORGAN,
Auctioneer and Stock Broker.
MERCHANT TAILOR,
W. W. AIAHA,
FINE SUITINGS, Scotch and American Goods.
New Restaurant.
WING WO TAI & COMPANY,
LATE INSURANCE CO.
ATLAS ASSURANCE COMPANY.

Wm. G. Irwin & Co.,
Commission Agents,
OCEANIC STEAMSHIP COMPANY
CHAS. HUSTACE,
Groceries and Provisions.
C. BREWER & CO., LTD.
GEO. H. HUDDY,
Dentist.
H. MAY & CO.,
Wholesale and Retail.
CROCCERS
HONOLULU IRON WORKS.
Pacific Brass Foundry
H. HACKFELD & CO.,
Commission Merchants
Agents
JAS. F. MORGAN,
Auctioneer and Stock Broker.
MERCHANT TAILOR,
W. W. AIAHA,
FINE SUITINGS, Scotch and American Goods.
New Restaurant.
WING WO TAI & COMPANY,
LATE INSURANCE CO.
ATLAS ASSURANCE COMPANY.

A Thorough Inspection.
Paints & Compounds
Roofing,
File Covering and Building Papers.
WM. G. IRWIN & Co.,
Agents for the Hawaiian Islands.
Castle & Cooke, Ltd.
Hardware and Commission Merchants,
General Merchandise,
Agricultural Implements and Plantation Supplies.
SANG CHAN,
Merchant Tailor.
KONG HOPKEE
FOOK ON & CO.,
CROCK CHEE & CO.,
HOP HING & COMPANY,
Castle & Cooke, Ltd.
Insurance Agents
WING WO TAI & COMPANY,
LATE INSURANCE CO.
ATLAS ASSURANCE COMPANY.