

PLAN
of the
TURRILL LOTS

KALIU, HONOLULU OAHU, HI.
Part of Royal Patent 1303
By C. J. Sproul Sur.
1877.

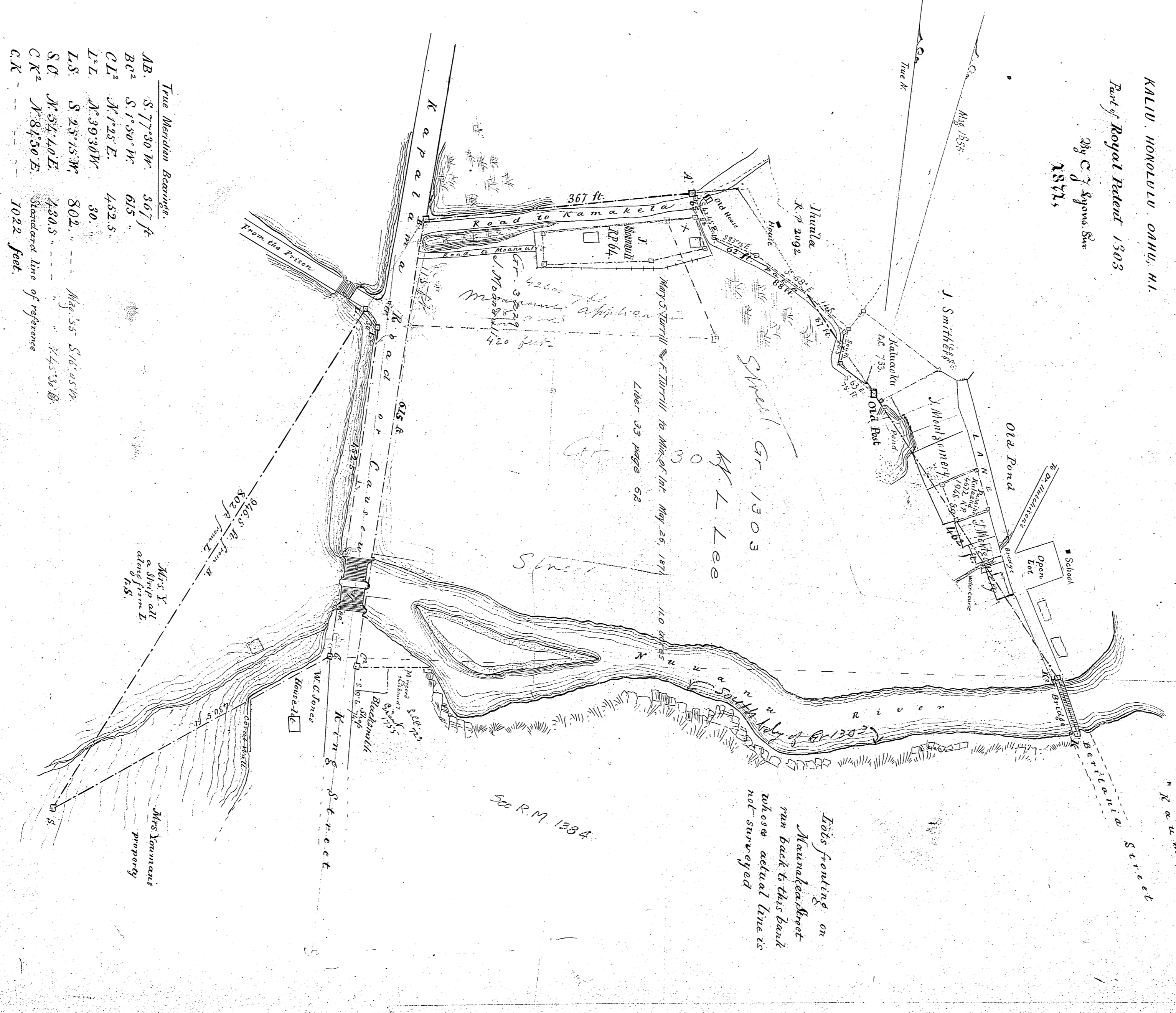

True Meridian Bearings.

AB.	S 77° 30' W.	367 ft.
BC ²	S 1° 30' W.	615
CD ²	N 7° 25' E.	452.5
L ² L.	N 39° 30' W.	30.
L.S.	S 23° 15' W.	802.
SD	N 52° 10' E.	430.5
CK ²	N 84° 50' E.	1022 feet

Standard line of reference
N 45° 33' B.

From Old Post to A. — N 39° 12' 20; N 9° 12' 20; N 39° 12' 87;
N 39° 12' 88; N 74° 12' 62; N 33° 32' 12' 65;

Markings located.

- At N & B, Lava stones marked +.
- L & Z² mark in coral edge of road.
- S. red-wood post.
- C. — 25 corner of fence, 69 ft. to edge of bridge.
- L. is 355 ft. from north end bar of bridge.
- L² is 37 ft. from hydrant F.P.

NOTE: --- Denotes boundary line of this property.

--- Kalaena boundaries by account.

--- Temporary fences.

Bearings written in blue are magnetic for 1855.

Declination of needle allowed for 1855, 9° 10' E.

Present declination at 1877, 9° 40' E.

Scale 1" = 300'

TURRILL LOTS
KALIU, HONOLULU
C. J. L. 1877

HAWAIIAN GOVERNMENT SURVEY.

Register No. 247

Drawer 15

Number 15

17-27-26